

Specifications

- Voltage rating: 250V AC, DC
- Current Rating: 3A, AC, DC
- Withstand voltage: 1000V AC/minute
- Contact resistance: 20mΩ max
- Insulation resistance: 1000MΩ min
- Temperature range: -40°C ~ +105°C
- Suitable JVT2518T series Terminal
JVT2518W series Wafer
- Compliant with RoHS and REACH
Contact JVT for details

Assembly layout

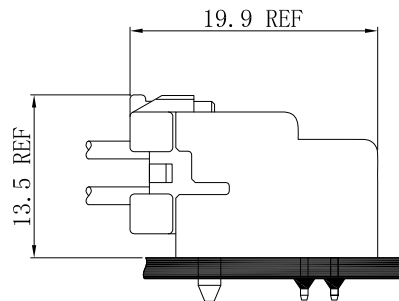
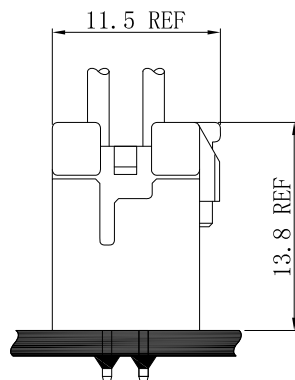

JVT2518H

2.5mm Pitch housing

HOUSING

Part No. : JVT2518HNO-2*XXL

Material: PA66 UL94V-0

Mates With Part(s): JVT2518 Terminal

JVT2518HNO-2*XXL

Logo
Series NO.
Housing
NO-PA66 UL94V-0
Lock
Pin NO.

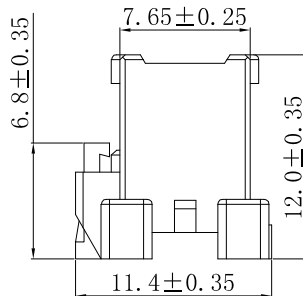
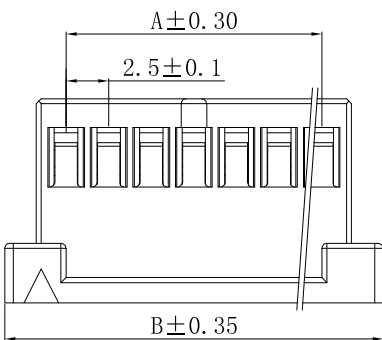
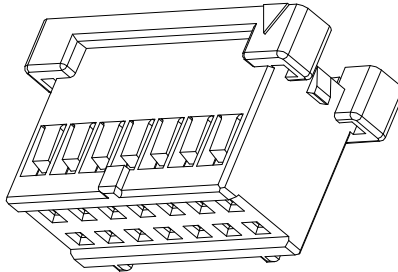
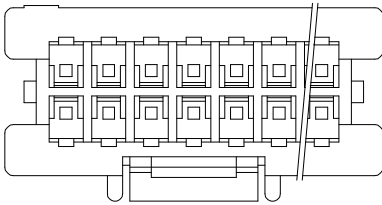

Poles	Dimensions		Poles	Dimensions	
	A	B		A	B
2*02	2.50	9.70	2*12	27.50	34.70
2*03	5.00	12.20	2*13	30.00	37.20
2*04	7.50	14.70	2*14	32.50	39.70
2*05	10.00	17.20	2*15	35.00	42.20
2*06	12.50	19.20	2*16	37.50	44.70
2*07	15.00	22.20	2*17	40.00	47.20
2*08	17.50	24.70	2*18	42.50	49.70
2*09	20.00	27.20	2*19	45.00	52.20
2*10	22.50	29.70	2*20	47.50	54.70
2*11	25.00	32.20			

JVT2518T

2.5mm Pitch Crimp Terminal

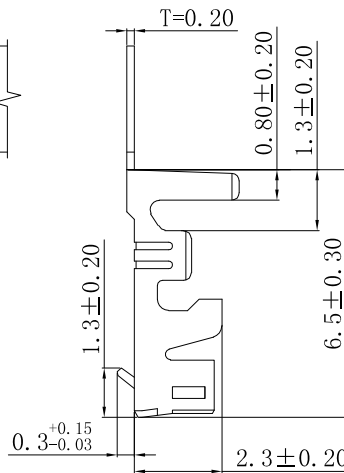
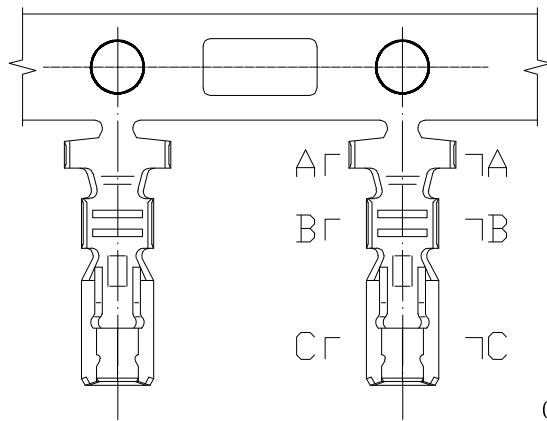

JVT2518TP-SNE

Logo
Series NO.
Terminal
Phosphor bronze
E-Plating before stamping
Tin Plated

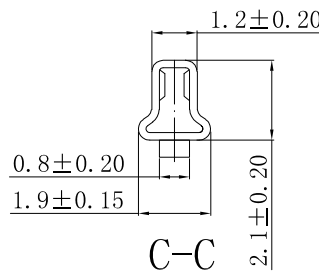
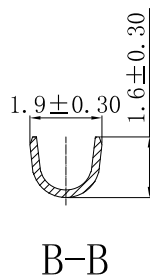
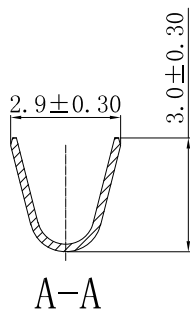

JVT2518TP-SNE	Phos Bronze	Tin Plated	AWG#20~28	1.90mm(Max)	JVT2518 HOUSING
PART NO	Material	Finish(Pin)	Wire Range	Insulation O.D.	Mates With Part(s)

JVT2518W

2.5mm Pitch Wafer-DIP TYPE

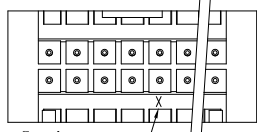

Cavity no.

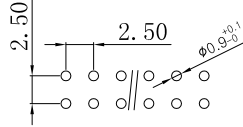

PCB LAYOUT

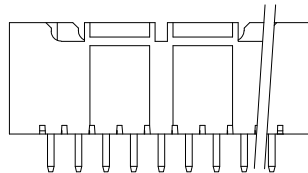
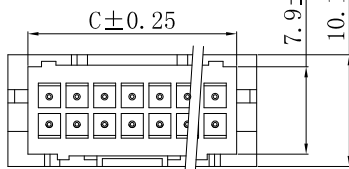
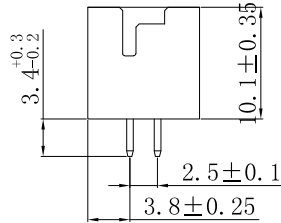
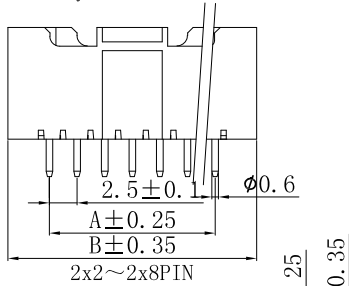
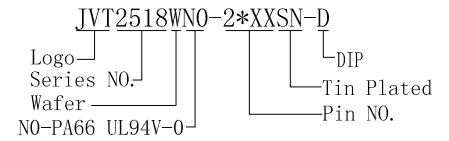

Poles	Dimensions			Poles	Dimensions		
	A	B	C		A	B	C
2*02	2.5	10.0	6.4	2*12	27.5	35.0	31.4
2*03	5.0	12.5	8.9	2*13	30.0	37.5	33.9
2*04	7.5	15.0	11.4	2*14	32.5	40.0	36.4
2*05	10.0	17.5	13.9	2*15	35.0	42.5	38.9
2*06	12.5	20.0	16.4	2*16	37.5	45.0	41.4
2*07	15.0	22.5	18.9	2*17	40.0	47.5	43.9
2*08	17.5	25.0	21.4	2*18	42.5	50.0	46.4
2*09	20.0	27.5	23.9	2*19	45.0	52.5	48.9
2*10	22.5	30.0	26.4	2*20	47.5	55.0	51.4
2*11	25.0	32.5	28.9				

JVT2518WN0-2*XXSN-D	PA66 UL94V-0	Brass	Tin Plated	JVT2518 Housing
PART NO	Material	Material(Pin)	Finish(Pin)	Mates With Part(s)

JVT2518W

2.5mm Pitch Wafer-DIP TYPE

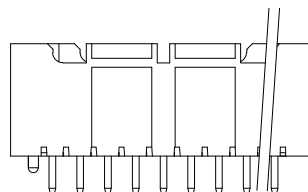
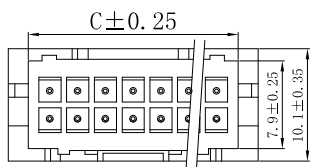
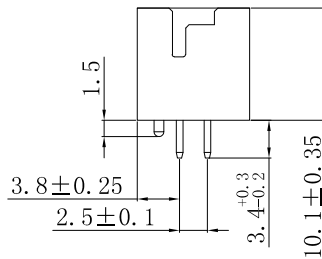
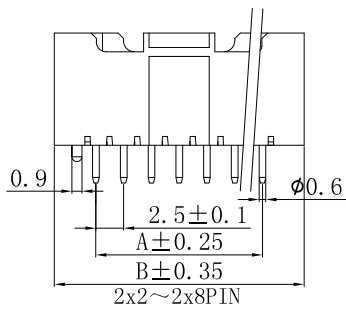
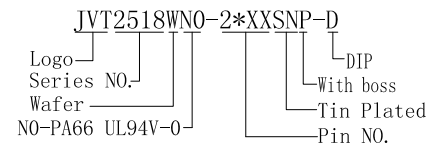
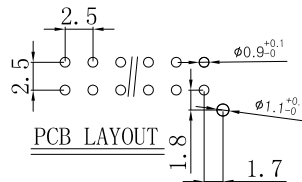
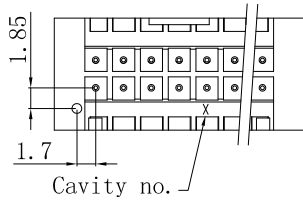

Poles	Dimensions			Poles	Dimensions		
	A	B	C		A	B	C
2*02	2.5	10.0	6.4	2*12	27.5	35.0	31.4
2*03	5.0	12.5	8.9	2*13	30.0	37.5	33.9
2*04	7.5	15.0	11.4	2*14	32.5	40.0	36.4
2*05	10.0	17.5	13.9	2*15	35.0	42.5	38.9
2*06	12.5	20.0	16.4	2*16	37.5	45.0	41.4
2*07	15.0	22.5	18.9	2*17	40.0	47.5	43.9
2*08	17.5	25.0	21.4	2*18	42.5	50.0	46.4
2*09	20.0	27.5	23.9	2*19	45.0	52.5	48.9
2*10	22.5	30.0	26.4	2*20	47.5	55.0	51.4
2*11	25.0	32.5	28.9				

JVT2518WN0-2*XXSNP-D	PA66 UL94V-0	Brass	Tin Plated	JVT2518 Housing
PART NO	Material	Material(Pin)	Finish(Pin)	Mates With Part(s)