

**JVT250T** — 250 Male TER

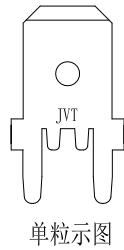

JVT250TB-XXSML-635

- Logo
- Series NO.
- T-Terminal
- B-Brass
- Width: 6.35mm
- L-With the fixed foot
- M-Male terminal
- S-Stamping before Plating
- SN-Tin Plated
- NI-Ni Plated

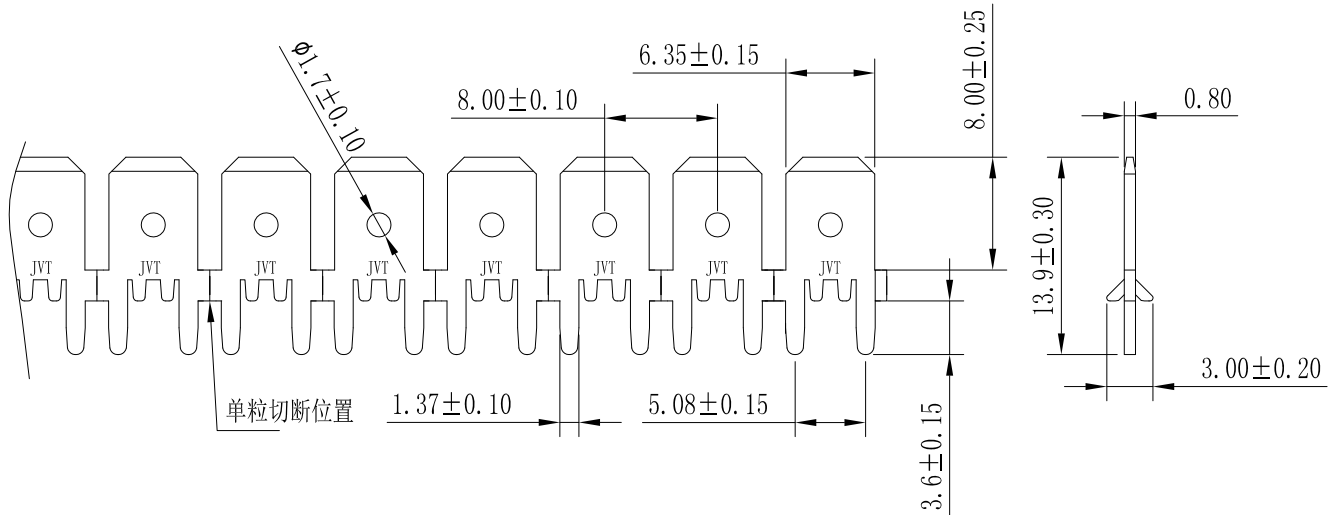

|                    |          |                         |            |                 |                    |
|--------------------|----------|-------------------------|------------|-----------------|--------------------|
| JVT250TB-XXSML-635 | Brass    | Tin Plated<br>Ni Plated | NA         | NA              | NA                 |
| PART NO            | Material | Finish(Pin)             | Wire Range | Insulation O.D. | Mates With Part(s) |

**JVT250T** — 250 Male TER

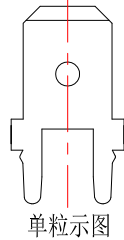

JVT250TB-HSNSM-635

- LOGO
- Series NO.
- T-Terminal
- B-Brass
- Width: 6.35mm
- M-Male terminal
- S-Stamping before Plating
- HSN-High temperature tin plating

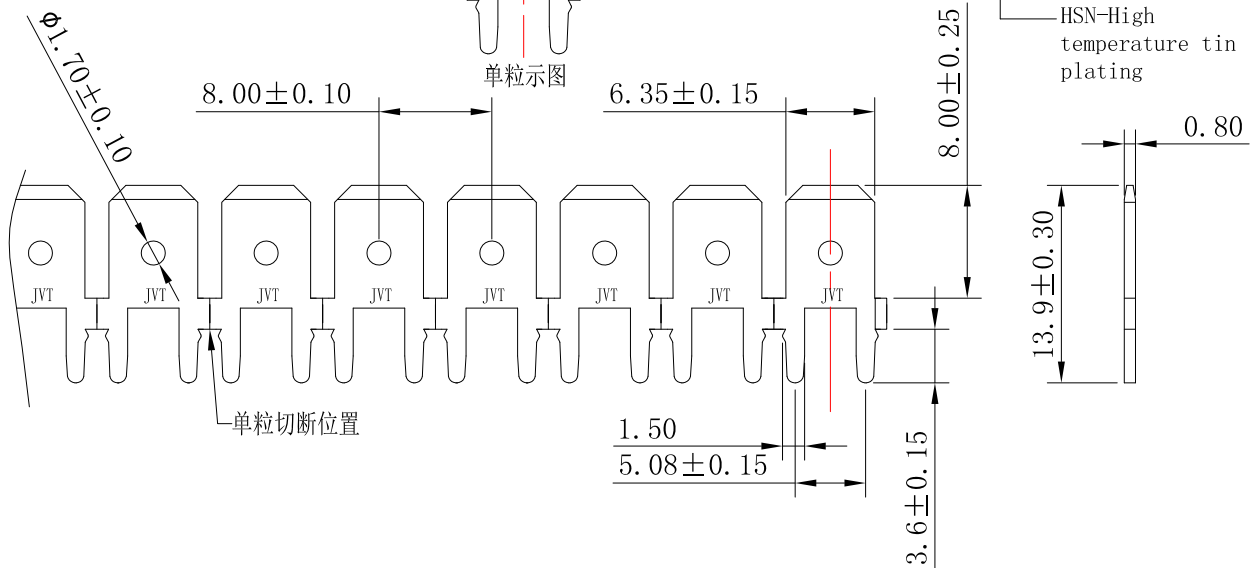

|                    |          |             |            |                 |                    |
|--------------------|----------|-------------|------------|-----------------|--------------------|
| JVT250TB-HSNSM-635 | Brass    | Tin Plated  | NA         | NA              | NA                 |
| PART NO            | Material | Finish(Pin) | Wire Range | Insulation O.D. | Mates With Part(s) |

JVT250T

250 Male TER

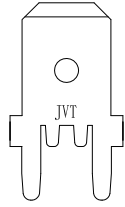

单粒示意图

JVT250TB-HSNSML-635

- LOGO
- Series NO.
- T-Terminal
- B-Brass
- Width: 6.35mm
- L-With the fixed foot
- M-Male terminal
- S-Stamping before Plating
- HSN-High temperature tin plating

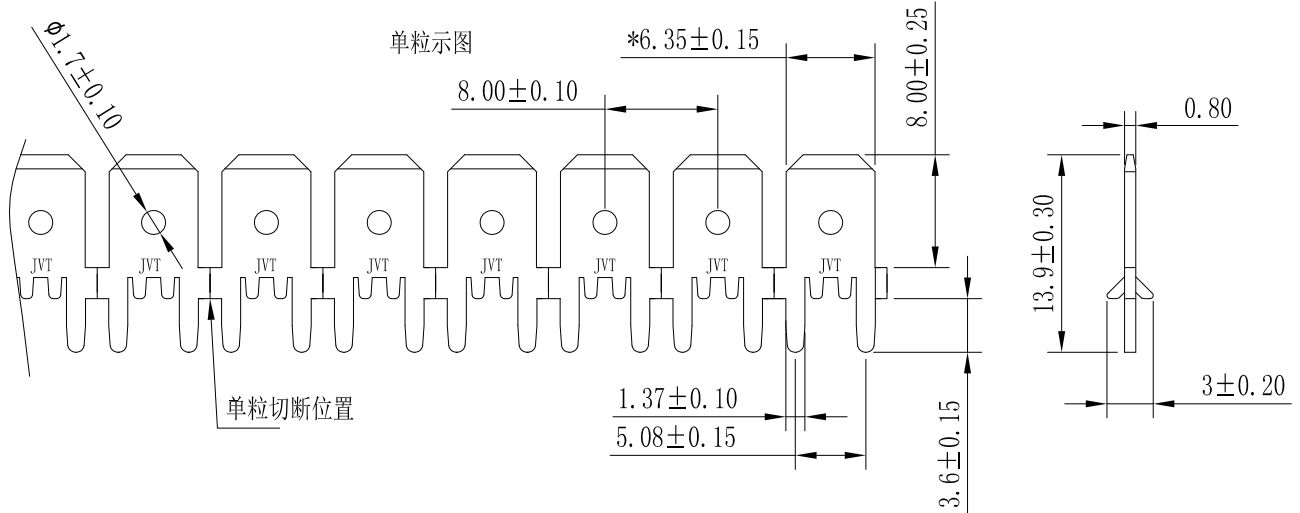

|                     |          |             |            |                 |                    |
|---------------------|----------|-------------|------------|-----------------|--------------------|
| JVT250TB-HSNSML-635 | Brass    | Tin Plated  | NA         | NA              | NA                 |
| PART NO             | Material | Finish(Pin) | Wire Range | Insulation O.D. | Mates With Part(s) |

**JVT250T**

250 The male TER

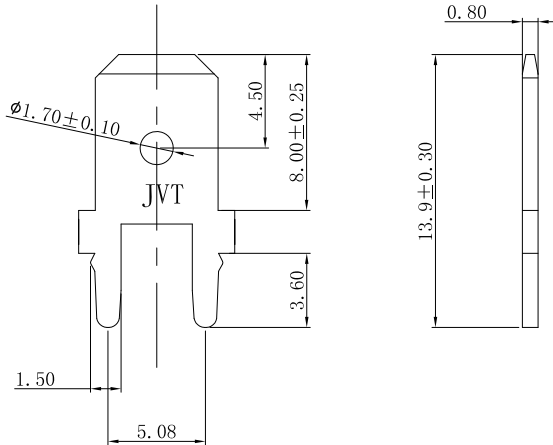

JVT250TB-HSNM-635-D  
 Logo  
 Series NO.  
 T-Terminal  
 B-Brass  
 HSN-High temperature  
 S-Stamping before Plating  
 Insert the width 6.35mm  
 The male TER

|                     |          |             |            |                 |                    |
|---------------------|----------|-------------|------------|-----------------|--------------------|
| JVT250TB-HSNM-635-D | Brass    | Tin Plated  | NA         | NA              | NA                 |
| PART NO             | Material | Finish(Pin) | Wire Range | Insulation O.D. | Mates With Part(s) |

**JVT250T**

250 The male TER

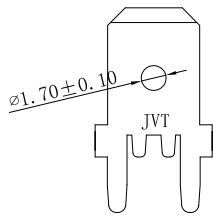

JVT250TB-HSNM-635-D  
 Logo  
 Series NO.  
 T-Terminal  
 B-Brass  
 HSN-High temperature  
 tin plating  
 Insert the width 6.35mm  
 L-Lock  
 M-Male TER  
 S-Stamping before Plating

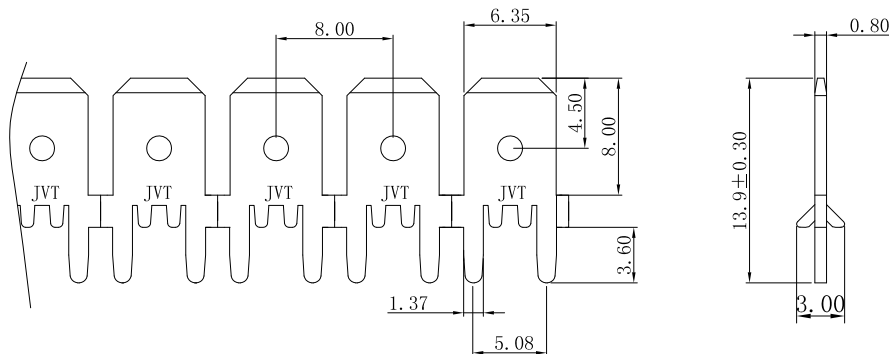

|                     |          |             |            |                 |                    |
|---------------------|----------|-------------|------------|-----------------|--------------------|
| JVT250TB-HSNM-635-D | Brass    | Tin Plated  | NA         | NA              | NA                 |
| PART NO             | Material | Finish(Pin) | Wire Range | Insulation O.D. | Mates With Part(s) |

**JVT250T** — 250 Female TER —

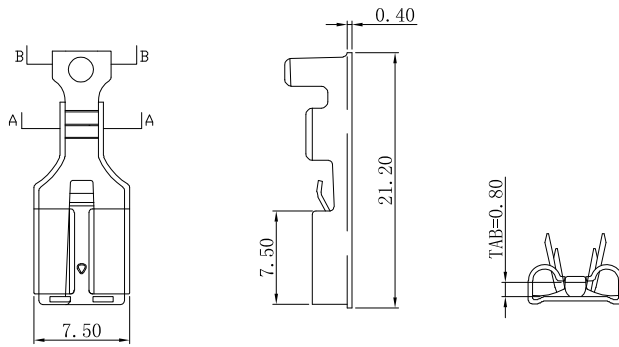

JVT250TB-SNSWL-T08  
 Logo —  
 Series NO. —  
 T-Termianl —  
 B-Brass —  
 — 0.8mm male side  
 — L-Lock  
 — W-Female TER  
 — S-Stamping before Plating  
 — SN-Tin-plated

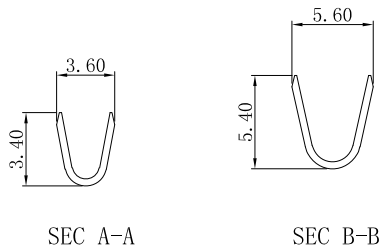

|                    |          |             |            |                  |                    |
|--------------------|----------|-------------|------------|------------------|--------------------|
| JVT250TB-SNSWL-T08 | Brass    | Tin Plated  | 16-18AWG   | NA               | NA                 |
| PART NO            | Material | Finish(Pin) | Wire Range | Insulation O. D. | Mates With Part(s) |

**JVT250T** — 250 Female TER —

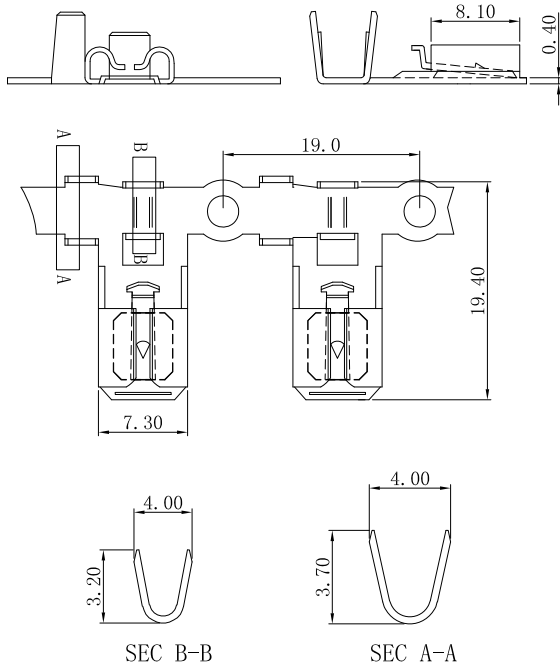

JVT2500TB-SNSWL-T08  
 Logo —  
 Series NO. —  
 T-Termianl —  
 B-Brass —  
 — 0.8mm male side  
 — L-Lock  
 — W-Female TER  
 — S-Stamping before Plating  
 — SN-Tin-plated

|                     |          |             |            |                  |                    |
|---------------------|----------|-------------|------------|------------------|--------------------|
| JVT2500TB-SNSWL-T08 | Brass    | Tin Plated  | 16-20AWG   | 3.10mm MAX       | NA                 |
| PART NO             | Material | Finish(Pin) | Wire Range | Insulation O. D. | Mates With Part(s) |