

JVT2009 SERIES

4.0mm pitch wire to board connector

Specifications

- Voltage rating: 600V AC, DC
- Current Rating: 1A, AC, DC
- Withstand voltage: 1800V AC/minute
- Contact resistance: 20mΩ max
- Insulation resistance: 1000mΩ min
- Temperature range: -40°C ~ +105°C
- Compliant with RoHS and REACH
- Contact JVT for details

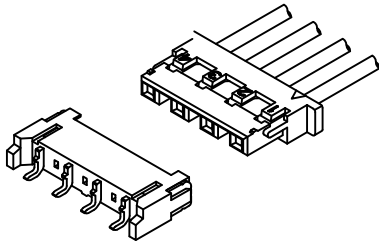

Assembly layout

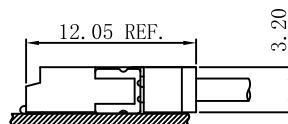

JVT2009 SERIES

4.0mm pitch wire to board connector

JVT2009H

4.0mm Pitch housing

HOUSING

Part No. : JVT2009HN0-XX

Material: Nylon 66 UL94V-0

Mates With Part(s): JVT2009 Terminal

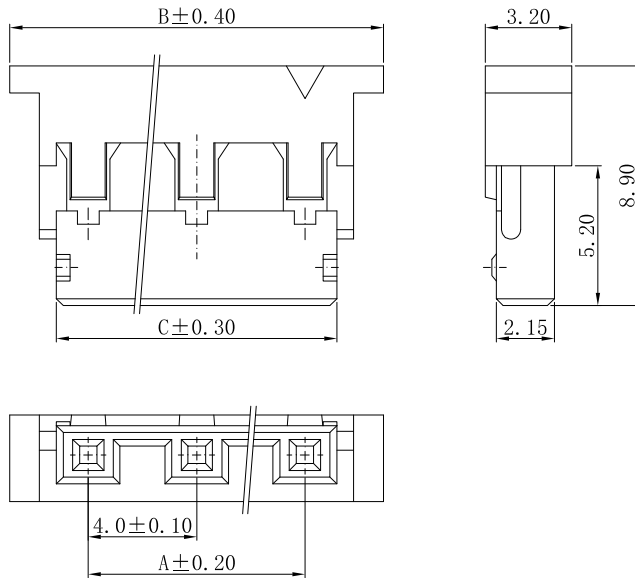

JVT2009HN0-XX
Logo
Series NO.
Housing
Pin NO.
NO-PA66 UL94V-0

Poles	DIM		
	A	B	C
2	4.00	9.80	6.35
3	8.00	13.80	10.35
4	12.00	17.80	14.35
5	16.00	21.80	18.35

JVT2009H

4.0mm Pitch housing

HOUSING

Part No. : JVT2009HN0-XXM

Material: Nylon 66 UL94V-0

Mates With Part(s): JVT2009 Terminal

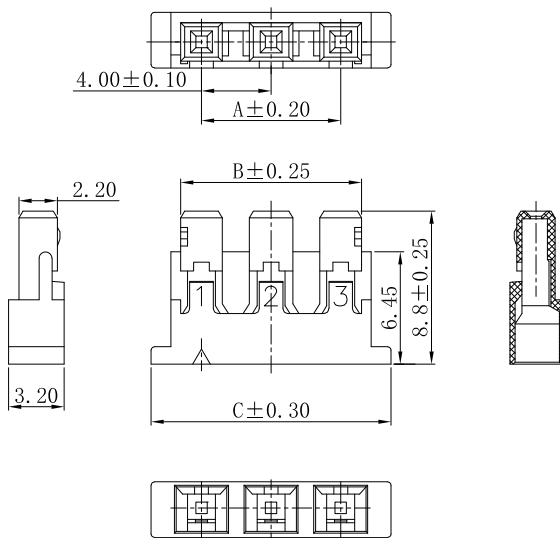

JVT2009HN0-XXM
Logo
Series NO.
Housing
Male HSG
Pin NO.
NO-PA66 UL94V-0

Poles	DIM		
	A	B	C
2	4.00	6.40	9.80
3	8.00	10.40	13.80
4	12.00	14.40	17.80
5	16.00	18.40	21.80

JVT2009 SERIES

4.0mm pitch wire to board connector

JVT2009H

4.0mm Pitch housing

HOUSING

Part No. : JVT2009HNO-XXW

Material: Nylon 66 UL94V-0

Mates With Part(s) : JVT2009 Terminal

JVT2009HNO-XXW
 logo—
 Series NO.—
 Housing—
 Female HSG
 Pin NO.
 NO-PA66 UL94V-0

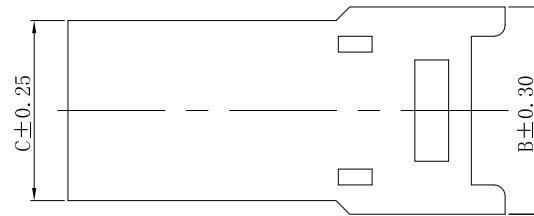
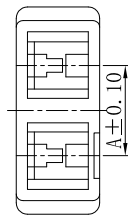
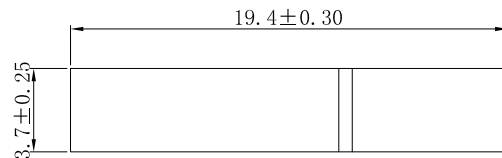

Poles	DIM		
	A	B	C
2	4.00	9.2	8.0
3	8.00	13.2	12.0
4	12.00	17.2	16.0
5	16.00	21.2	20.0

JVT2009T

4.0mm Pitch Crimp Terminal

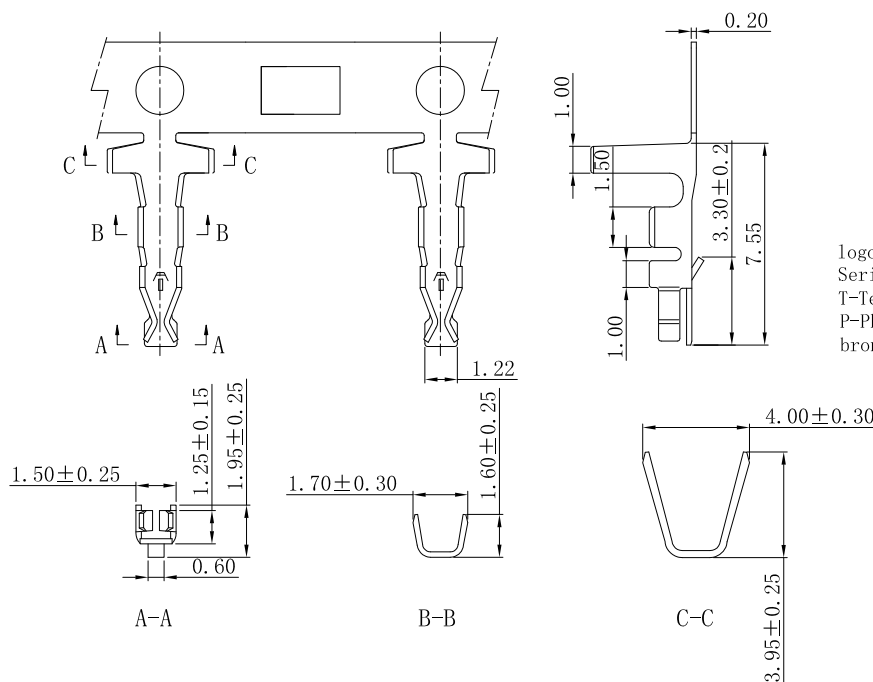

JVT2009TP-SNX
 logo—
 Series NO.—
 T-Terminal
 P-Phosphor
 bronze
 S-Stamping before
 Plating
 E-Plating before
 stamping
 SN-Tin Plated

JVT2009TP-SNX	Phos Bronze	Tin Plated	AWG#22~28	3.2mm(Max)	JVT2009 HOUSING
PART NO	Material	Finish(Pin)	Wire Range	Insulation O.D.	Mates With Part(s)

JVT2009 SERIES

4.0mm pitch wire to board connector

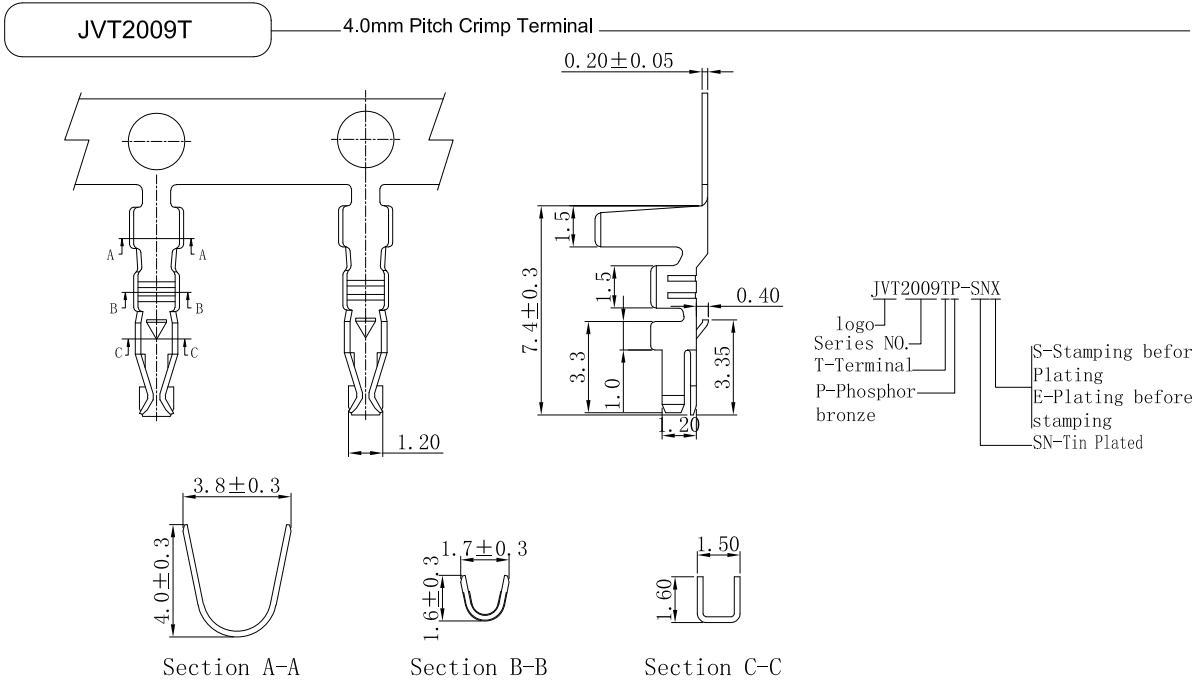

JVT2009TP-SNXM	Phos Bronze	Tin Plated	AWG#22~28	3.2mm(Max)	JVT2009 HOUSING
PART NO	Material	Finish(Pin)	Wire Range	Insulation O.D.	Mates With Part(s)

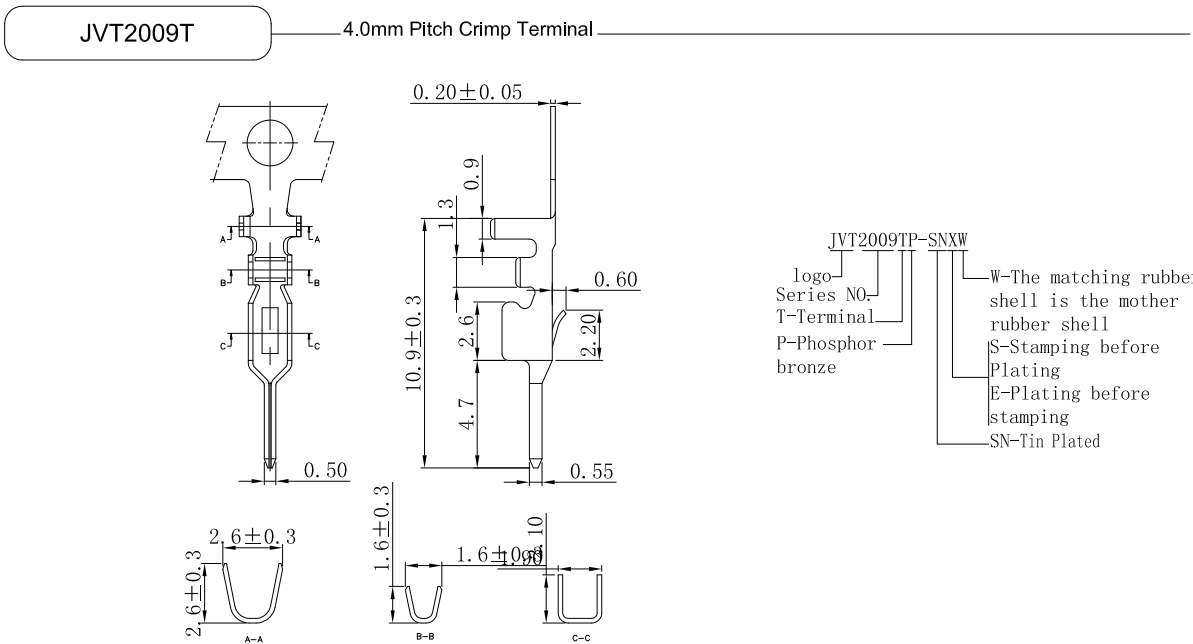

JVT2009TP-SNXW	Phos Bronze	Tin Plated	AWG#22~28	3.2mm(Max)	JVT2009 HOUSING
PART NO	Material	Finish(Pin)	Wire Range	Insulation O.D.	Mates With Part(s)

JVT2009 SERIES

4.0mm pitch wire to board connector

JVT2009W

4.0mm Pitch 90°Wafer-SMT TYPE

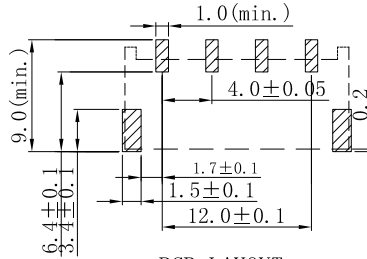
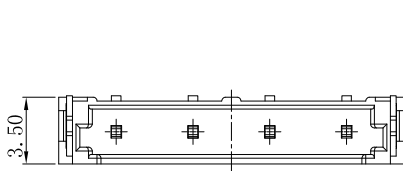

PCB LAYOUT

JVT2009W9T-XXSNR-S
 logo — SMT
 Series NO. — R-Right Angle 90°
 Wafer — Tin Plated
 9T-PA9T UL94V-0 — Pin NO.

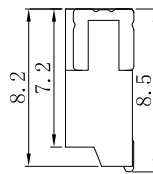
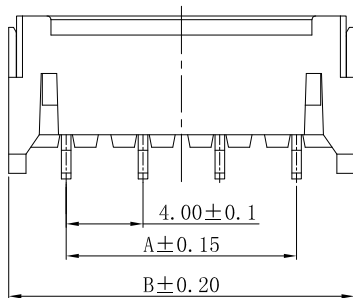

Poles	A	B
2	4.0	10.0
3	8.0	14.0
4	12.0	18.0
5	16.0	22.0

JVT2009W9T-XXSNR-S	PA9T UL94V-0	Brass	Tin plating	Phosphor bronze	JVT2009 Housing
PART NO	Material	Material(Pin)	Finish(Pin)	Material (Solder Tabs)	Mates With Part(s)