

Specifications

- Voltage rating: 250V AC, DC
- Current Rating: 5A, AC, DC
- Withstand voltage: 1500V AC/minute
- Contact resistance: 20m Ω max
- Insulation resistance: 1000m Ω min
- Temperature range: -40 $^{\circ}$ C ~ +105 $^{\circ}$ C
- Compliant with RoHS and REACH
- Contact JVT for details

Assembly layout

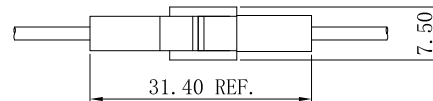
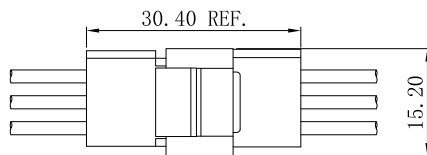

JVT23158/24158 SERIES 3.68mm pitch wire to wire connector

JVT24158H

3.68mm Pitch housing

HOUSING

Part No. : JVT24158HN2-01
Material: Nylon 66 UL94V-2
Mates With Part(s) : JVT24158 Terminal

JVT24158HN2-01
Logo Series NO. Housing Pin NO. N2-PA66 UL94V-2

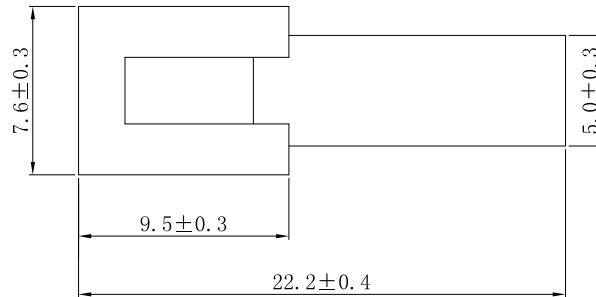
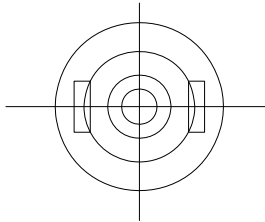

JVT24158H

3.68mm Pitch housing

HOUSING

Part No. : JVT24158HN2-02
Material: Nylon 66 UL94V-2
Mates With Part(s) : JVT24158 Terminal

JVT24158HN2-02
Logo Series NO. Housing Pin NO. N2-PA66 UL94V-2

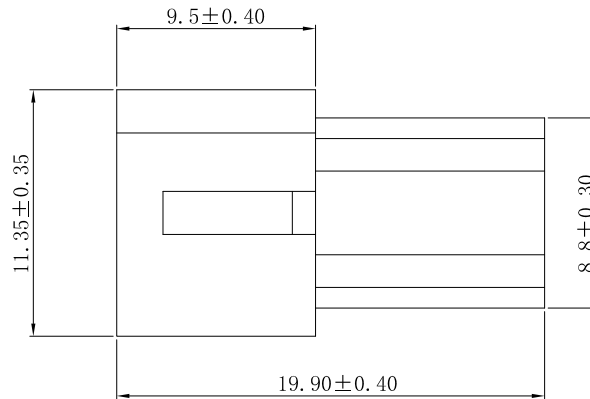
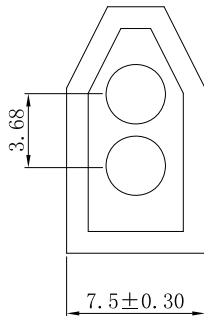

JVT23158/24158 SERIES 3.68mm pitch wire to wire connector

JVT24158H

3.68mm Pitch housing

HOUSING

Part No. : JVT24158HN2-02L

Material: Nylon 66 UL94V-2

Mates With Part(s) : JVT24158 Terminal

JVT24158HN2-02L
Logo
Series NO.
Housing
L-Lock
Pin NO.
N2-PA66 UL94V-2

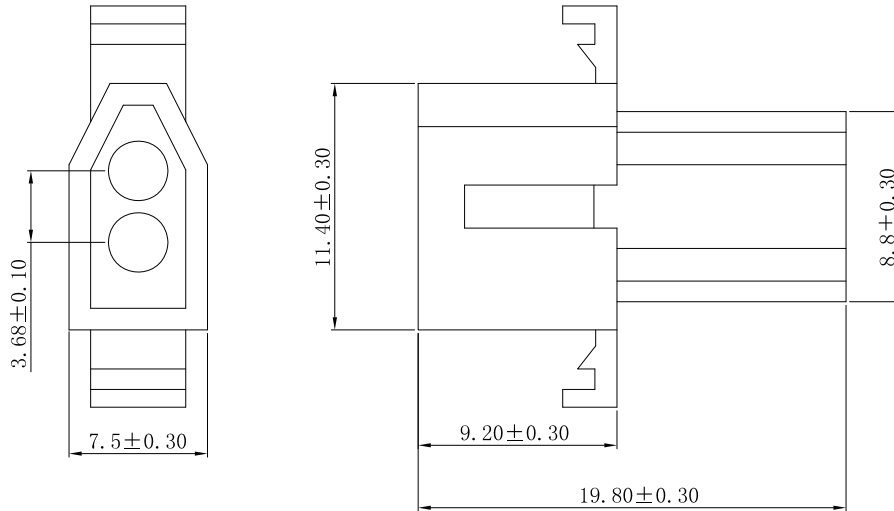

JVT24158H

3.68mm Pitch housing

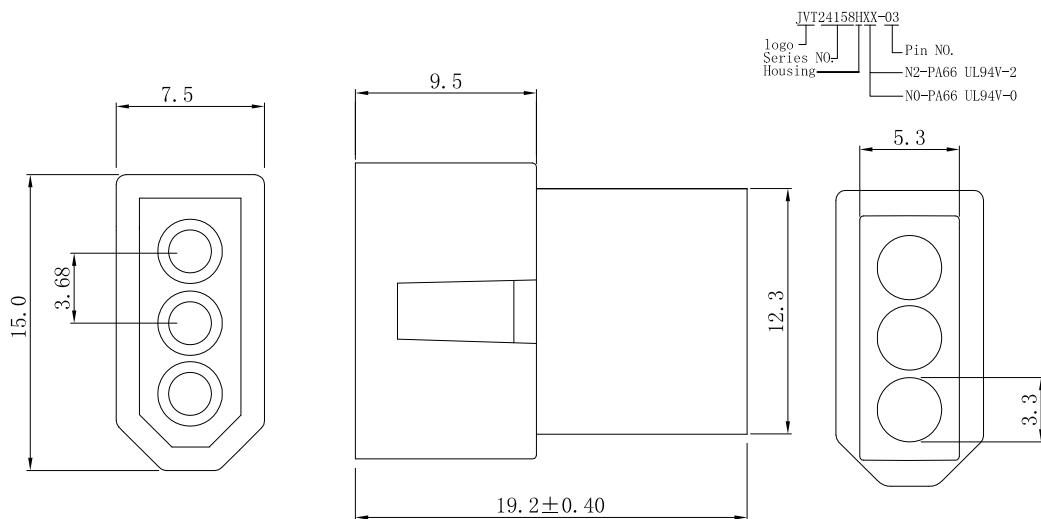

JVT24158HXX-03
Logo
Series NO.
Housing
Pin NO.
N2-PA66 UL94V-2
N0-PA66 UL94V-0

JVT24158HN2-03	PA66 UL94V-2	JVT24158TB-SNX
JVT24158HN0-03	PA66 UL94V-0	JVT24158TB-SNX
PART NO	Material	Mates With Part(s)

JVT23158/24158 SERIES 3.68mm pitch wire to wire connector

JVT24158H

3.68mm Pitchhousing

HOUSING

Part No. : JVT3502HN0-XXL

Material: Nylon 66 UL94V-0

Mates With Part(s): JVT3502 Terminal

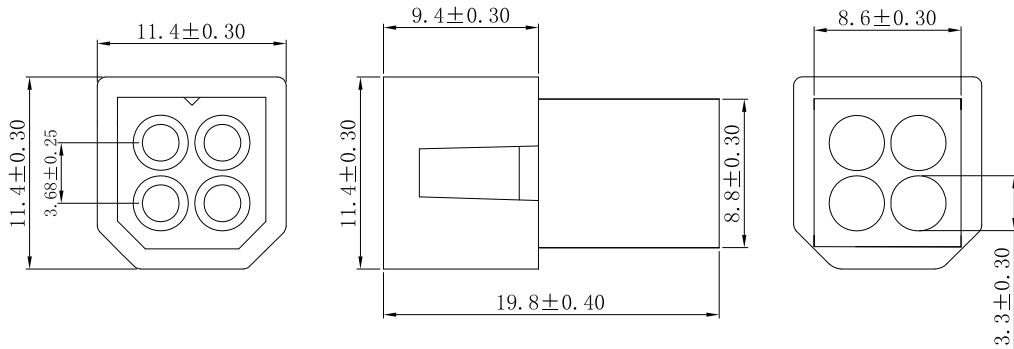
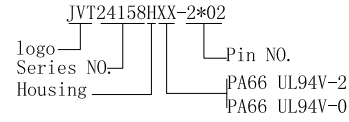

JVT24158HN2-2*02	PA66 UL94V-2	JVT24158TB-SNX
JVT24158HN0-2*02	PA66 UL94V-0	JVT24158TB-SNX
PART NO	Material	Mates With Part(s)

JVT24158T

3.68mm Pitch Crimp Terminal

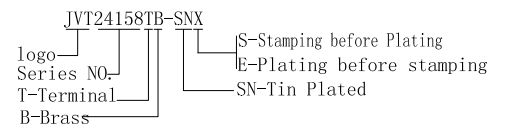
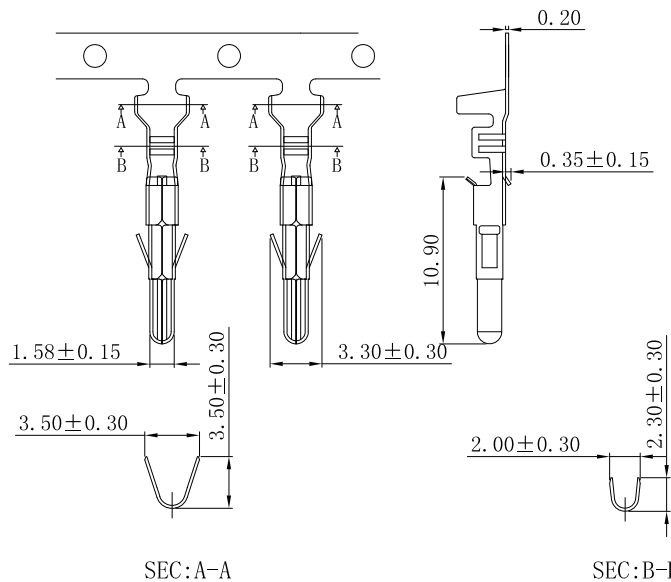

JVT24158TB-SNX	Brass	Tin Plated	AWG#18-24	2.7mm(Max)	JVT24158 HOUSING
PART NO	Material	Finish(Pin)	Wire Range	Insulation O.D.	Mates With Part(s)

JVT23158/24158 SERIES 3.68mm pitch wire to wire connector

JVT23158H

3.68mm Pitch housing

HOUSING

Part No. : JVT23158HN2-01

Material: Nylon 66 UL94V-2

Mates With Part(s): JVT23158 Terminal

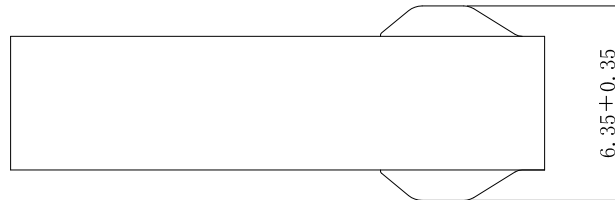
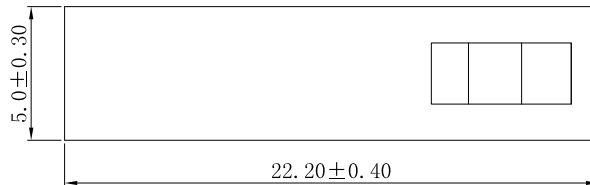
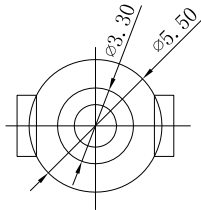
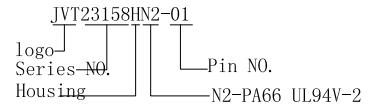

JVT23158H

3.68mm Pitch housing

HOUSING

Part No. : JVT23158HN2-02

Material: Nylon 66 UL94V-2

Mates With Part(s): JVT23158 Terminal

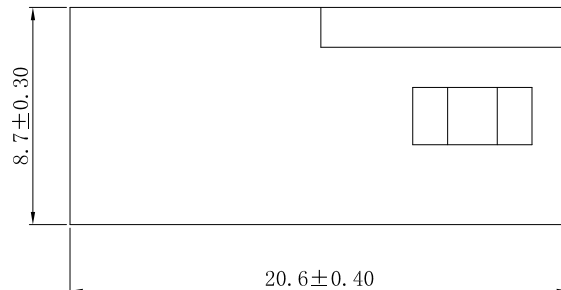
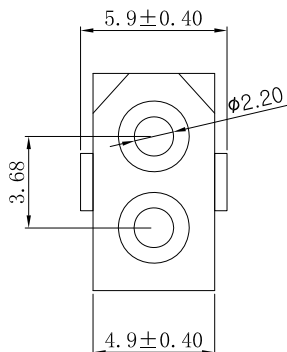
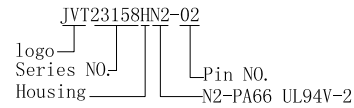

JVT23158/24158 SERIES

3.68mm pitch wire to wire connector

JVT23158H

3.68mm Pitch housing

HOUSING

Part No. : JVT23158HN2-02L

Material: Nylon 66 UL94V-2

Mates With Part(s) : JVT23158 Terminal

JVT23158HN2-02L
 Logo
 Series NO.
 Housing
 L-Lock
 Pin NO.
 N2-PA66 UL94V-2

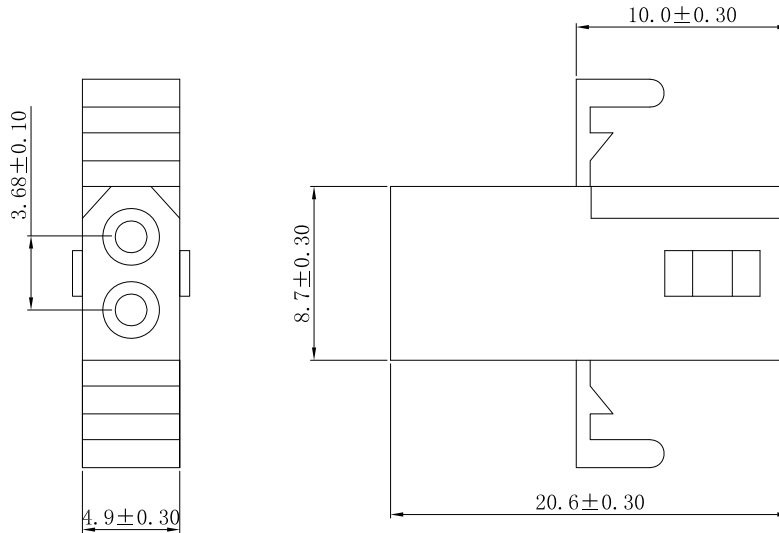

JVT23158H

3.68mm Pitch housing

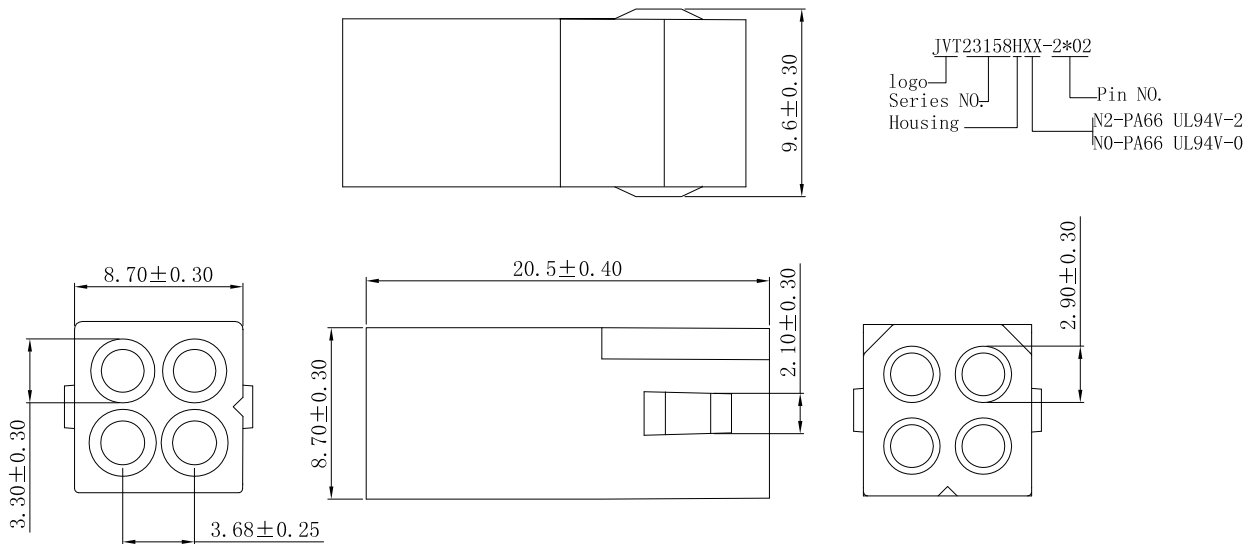

JVT23158HXX-2*02
 Logo
 Series NO.
 Housing
 Pin NO.
 N2-PA66 UL94V-2
 N0-PA66 UL94V-0

JVT23158HN2-2*02	PA66 UL94V-2	JVT23158TB-SNX
JVT23158HN0-2*02	PA66 UL94V-0	JVT23158TB-SNX
PART NO	Material	Mates With Part(s)

JVT23158/24158 SERIES 3.68mm pitch wire to wire connector

JVT23158T 3.68mm Crimp Terminal

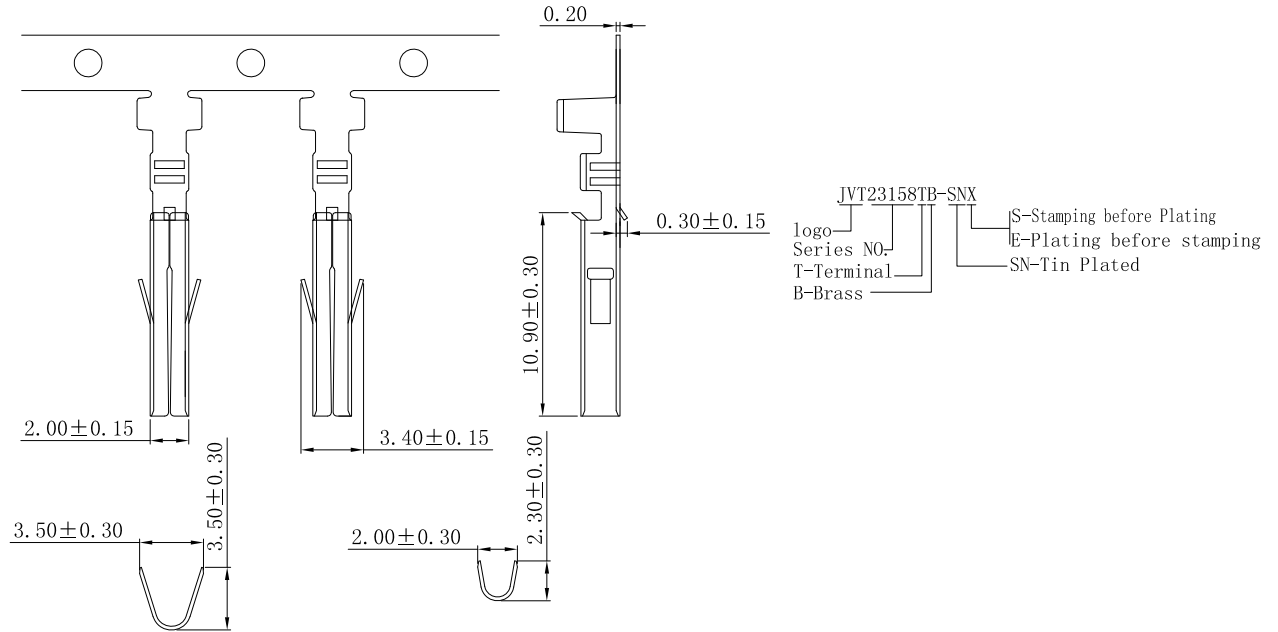

JVT23158TB-SNX	Brass	Tin Plated	AWG#18~24	2.7mm(Max)	JVT23158 HOUSING
PART NO	Material	Finish(Pin)	Wire Range	Insulation O.D.	Mates With Part(s)