

Specifications

- Voltage rating: 125V AC, DC
- Current Rating: 2A, AC, DC
- Withstand voltage: 1000V AC/minute
- Contact resistance: 20mΩ max
- Insulation resistance: 1000mΩ min
- Temperature range: -40°C ~ +105°C
- Compliant with RoHS and REACH
- Contact JVT for details

Assembly layout

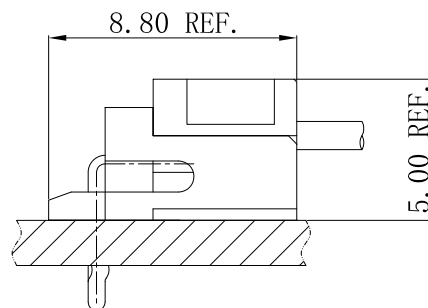
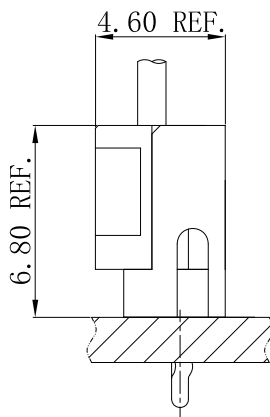

JVT2005 SERIES

2.0mm pitch wire to board connector

JVT2005H

2.0mm Pitch housing

HOUSING

Part No. : JVT2005HN0-XX

Material: Nylon 66 UL94V-0

Mates With Part(s): JVT2005 Terminal

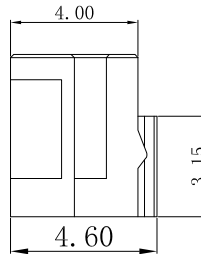
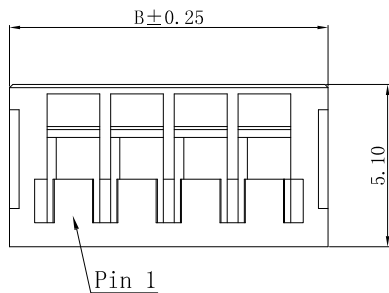
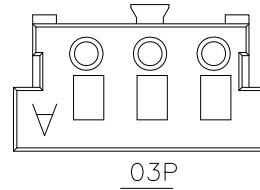
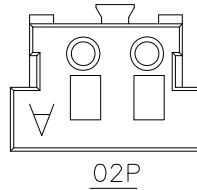
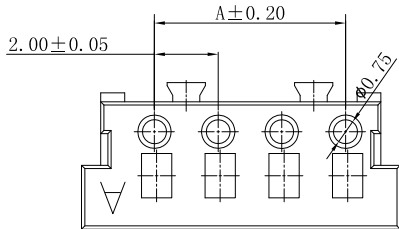
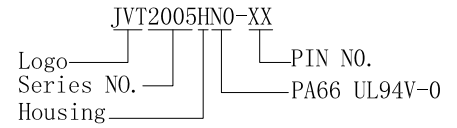

Poles	Dimensions mm	
	A	B
02	2.00	6.00
03	4.00	8.00
04	6.00	10.00
05	8.00	12.00
06	10.00	14.00
07	12.00	16.00
08	14.00	18.00
09	16.00	20.00
10	18.00	22.00
11	20.00	24.00
12	22.00	26.00
13	24.00	28.00
14	26.00	30.00
15	28.00	32.00

JVT2005T

2.0mm Pitch Crimp Terminal

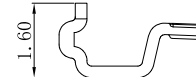
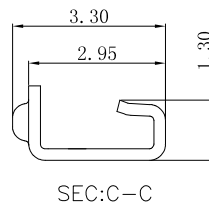
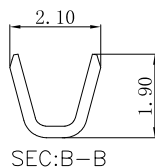
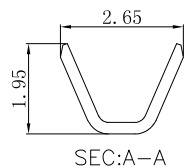
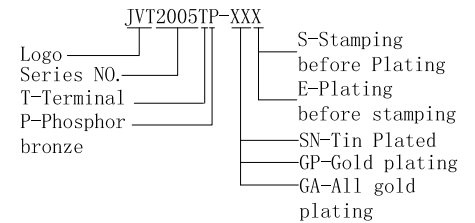
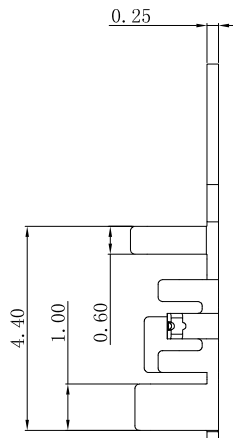
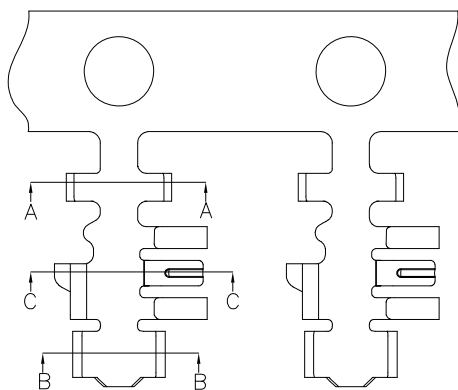

JVT2005TP-SNS	Phos Bronze	Tin Plated	AWG#22~26	1.5mm(Max)	JVT2005 HOUSING
PART NO	Material	Finish(Pin)	Wire Range	Insulation O.D.	Mates With Part(s)

JVT2005 SERIES

2.0mm pitch wire to board connector

JVT2006W

2.0mm Pitch Wafer-DIP TYPE

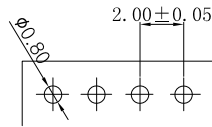
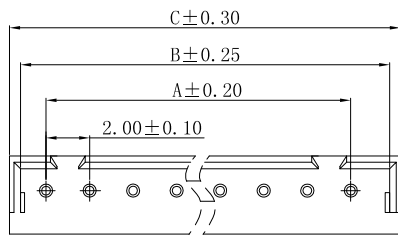

P.C.B. Layout

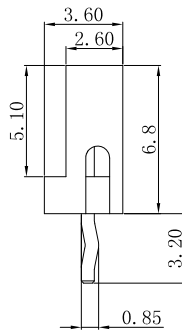
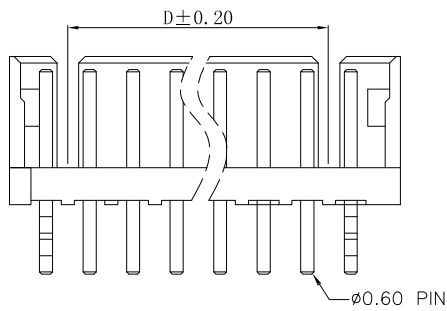

JVT2006WN0-XXSN-D
Logo _____
Series NO. _____
Wafer _____
PA66 UL94V-0 _____
DIP _____
SN-Tin Plated _____
GA-All gold plating _____
Pin NO. _____

PIN	DIM. (mm)			
	A	B	C	D
2	2.00	4.96	5.96	—
3	4.00	6.96	7.96	—
4	6.00	8.96	9.96	4.00
5	8.00	10.96	11.96	6.00
6	10.00	12.96	13.96	8.00
7	12.00	14.96	15.96	10.00
8	14.00	16.96	17.96	12.00
9	16.00	18.96	19.96	14.00
10	18.00	20.96	21.96	16.00
11	20.00	22.96	23.96	18.00
12	22.00	24.96	25.96	20.00
13	24.00	26.96	27.96	22.00
14	26.00	28.96	29.96	24.00
15	28.00	30.96	31.96	26.00

JVT2006WN0-XXGA-D	PA66 UL94V-0	Brass	Gold plating	Brass	JVT2005 Housing
JVT2006WN0-XXSN-D			Tin plating		
PART NO	Material	Material(Pin)	Finish(Pin)	Material (Solder Tabs)	Mates With Part(s)

JVT2006W

2.0mm Pitch 90°Wafer-DIP TYPE

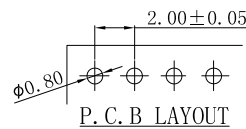
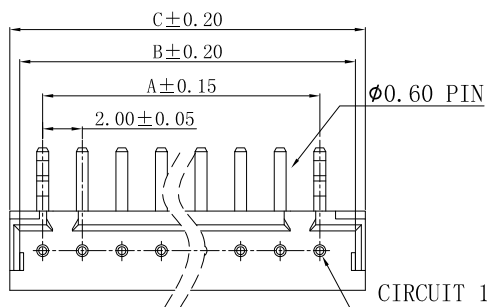

P. C. B LAYOUT

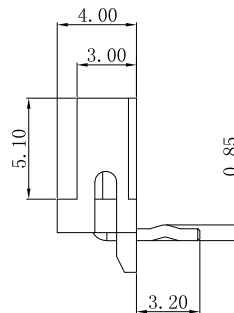
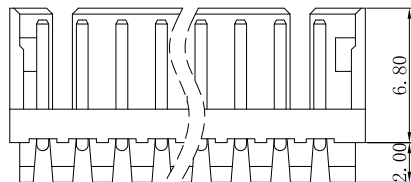

JVT2006WN0-XXXXR-D
Logo _____
Series NO. _____
Wafer _____
PA66 UL94V-0 _____
PIN数 _____
DIP _____
R-90° _____
SN-Tin Plated _____
GA-All gold plating _____

PIN	DIM. (mm)		
	A	B	C
2	2.00	4.96	5.96
3	4.00	6.96	7.96
4	6.00	8.96	9.96
5	8.00	10.96	11.96
6	10.00	12.96	13.96
7	12.00	14.96	15.96
8	14.00	16.96	17.96
9	16.00	18.96	19.96
10	18.00	20.96	21.96
11	20.00	22.96	23.96
12	22.00	24.96	25.96
13	24.00	26.96	27.96
14	26.00	28.96	29.96
15	28.00	30.96	31.96

JVT2006WN0-XXGAR-D	PA66 UL94V-0	Brass	Gold plating	Brass	JVT2005 Housing
JVT2006WN0-XXSNR-D			Tin plating		
PART NO	Material	Material(Pin)	Finish(Pin)	Material (Solder Tabs)	Mates With Part(s)