

Specifications

- Voltage rating: 150V AC, DC
- Current Rating: 1A, AC, DC
- Withstand voltage: 500V AC/minute
- Contact resistance: 30mΩ max
- Insulation resistance: 500MΩ min
- Temperature range: -40°C ~ +105°C
- Compliant with RoHS and REACH
- Contact JVT for details

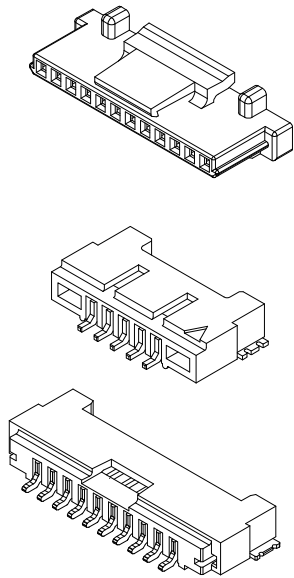

Assembly layout

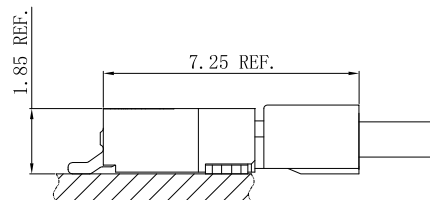
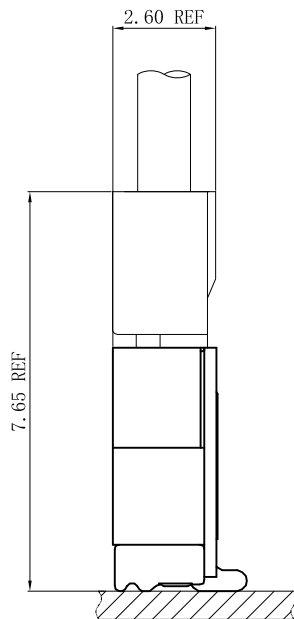

JVT1225 SERIES

1.25mm pitch wire to board connector

JVT1225H

1.25mm Pitch housing

HOUSING

Part No. : JVT1225HNO-XX

Material: PA66 UL94V-0

Mates With Part(s): JVT1225 Terminal

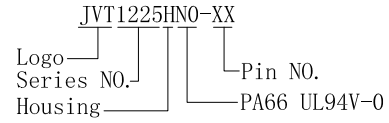

02P

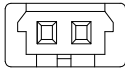

03~30P

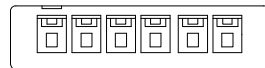
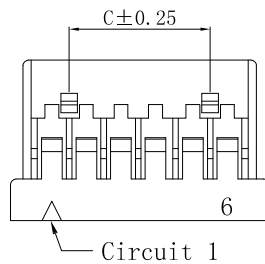
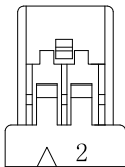
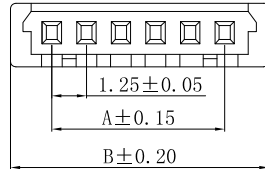

Poles	Dimensions (mm)		
	A	B	C
02	1.25	4.35	—
03	2.50	5.60	1.25
04	3.75	6.85	2.50
05	5.00	8.10	3.75
06	6.25	9.35	5.00
07	7.50	10.60	6.25
08	8.75	11.85	7.50
09	10.00	13.10	8.75
10	11.25	14.35	10.00
11	12.50	15.60	11.25
12	13.75	16.85	12.50
13	15.00	18.10	13.75
14	16.25	19.35	15.00
15	17.50	20.60	16.25
20	23.75	26.85	22.50
25	30.00	33.10	28.75
30	36.25	39.35	35.00

Unit:mm

JVT1225H

1.25mm Pitch housing

HOUSING

Part No. : JVT1225HNO-XXL

Material: PA66 UL94V-0

Mates With Part(s): JVT1225 Terminal

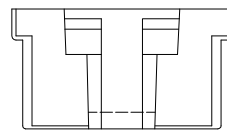
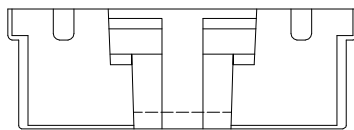
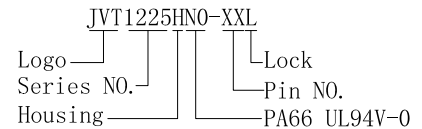

11P~30P

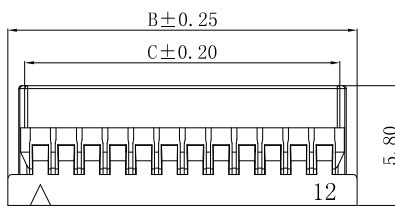
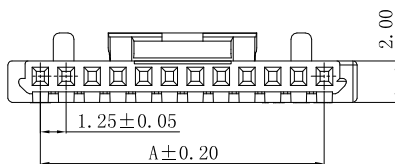

Circuit 1

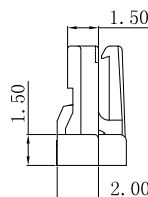

Poles	Dimensions (mm)			
	A	B	C	D
02	1.25	4.40	2.75	1.10
03	2.50	5.65	4.00	1.95
04	3.75	6.90	5.25	3.20
05	5.00	8.15	6.50	3.20
06	6.25	9.40	7.75	3.20
07	7.50	10.65	9.00	3.20
08	8.75	11.90	10.25	3.20
09	10.00	13.15	11.50	3.20
11	11.25	14.40	12.75	3.20
12	12.50	15.65	14.00	4.70
13	13.75	16.90	15.25	4.70
14	15.00	18.15	16.50	4.70
15	16.25	19.40	17.75	4.70
16	17.50	20.65	19.00	4.70
20	23.75	26.90	25.25	4.70
25	30.00	33.15	31.50	5.70
30	36.25	39.40	37.75	5.70

Unit:mm

JVT1225 SERIES

1.25mm pitch wire to board connector

JVT1225T

1.25mm Pitch Crimp Terminal

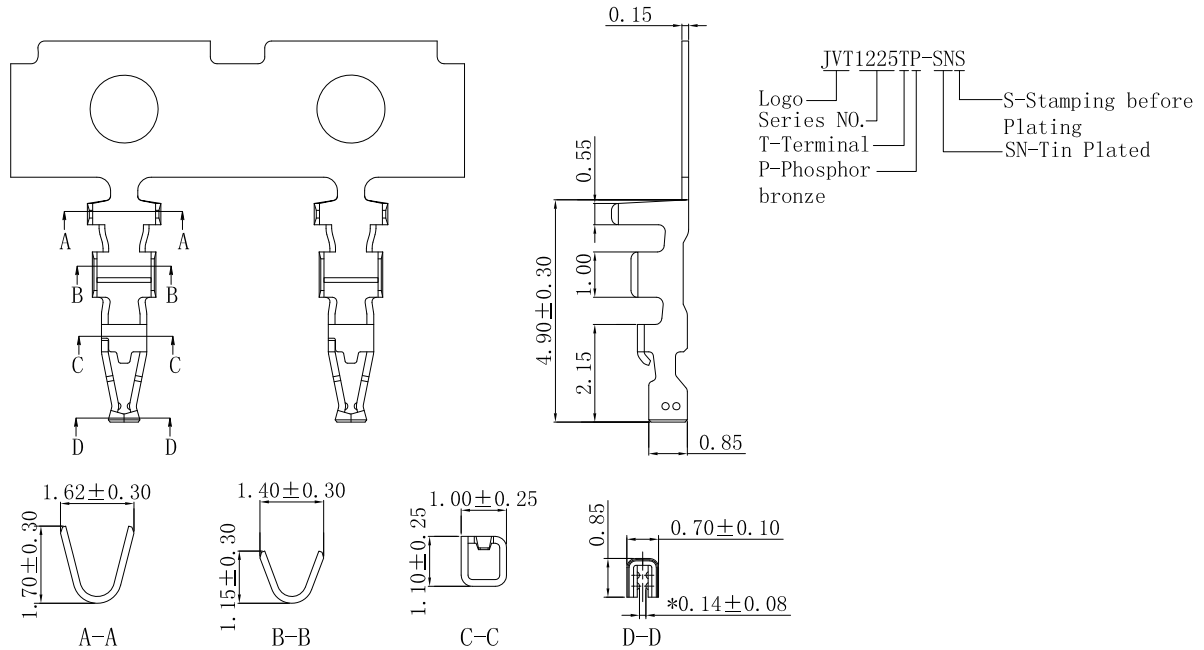

JVT1225TP-SNS	Phos Bronze	Tin Plated	AWG#26~32	1.0mm(Max)	JVT1225 HOUSING
PART N0	Material	Finish(Pin)	Wire Range	Insulation O.D.	Mates With Part(s)

JVT1225T

1.25mm Pitch Crimp Terminal

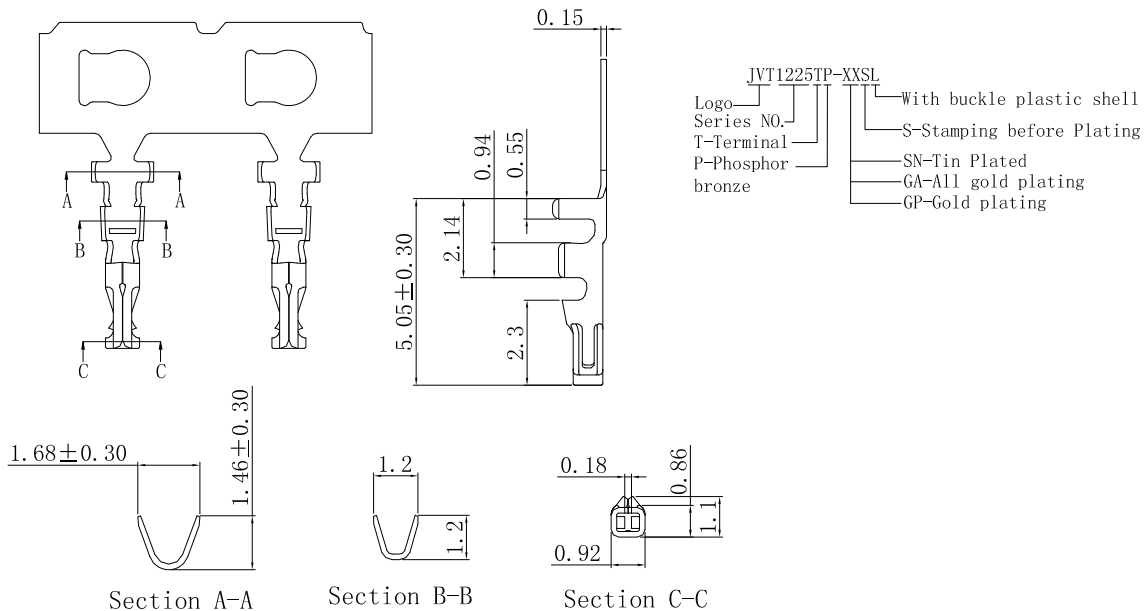

JVT1225TP-GPSL	Phos Bronze	Half Gold	AWG#28~32	0.9mm(Max)	JVT1225 HOUSING
JVT1225TP-GASL		Gold Plated			
JVT1225TP-SNSL		Tin Plated			
PART N0	Material	Finish(Pin)	Wire Range	Insulation O.D.	Mates With Part(s)

JVT1225 SERIES

1.25mm pitch wire to board connector

JVT1225W

1.25mm Pitch 90° Wafer-SMT TYPE

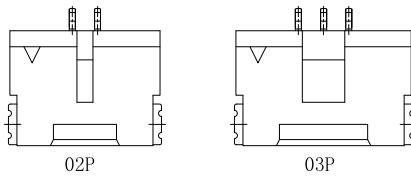

JVT1225WXX-XXSNR-S
 Logo
 Series NO.
 Wafer
 LP-LCP UL94V-0
 6T-PA6T UL94V-0
 S-SMT
 R-Right Angle 90°
 SN-Tin Plated
 Pin NO.

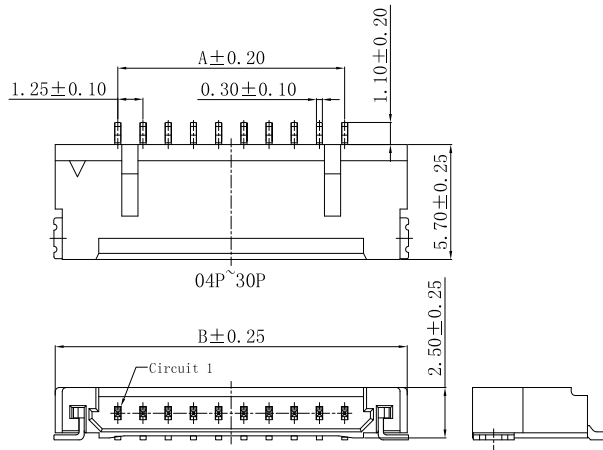

POLES	Dimensions		POLES	Dimensions	
	A	B		A	B
02	1.25	7.45	11	12.50	18.70
03	2.50	8.70	12	13.75	19.95
04	3.75	9.95	13	15.00	21.20
05	5.00	11.20	14	16.25	22.45
06	6.25	12.45	15	17.50	23.70
07	7.50	13.70	20	23.75	29.95
08	8.75	14.95	25	30.00	36.20
09	10.00	16.20	30	36.25	42.45
10	11.25	17.45			

Unit:mm

JVT1225W6T-XXSNR-S	PA6T UL94V-0	Brass	Tin Plated	Brass	Tin Plated	JVT1225 Housing
JVT1225WLP-XXSNR-S	LCP UL94V-0					
PART NO	Material	Material(Pin)	Finish(Pin)	Material (Solder Tabs)	Finish (Solder Tabs)	Mates With Part(s)

JVT1225W

1.25mm Pitch Wafer-SMT TYPE

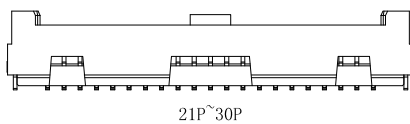

JVT1225W9T-XXSNL-S
 Logo
 Series NO.
 Wafer
 PA9T UL94V-0
 S-SMT
 Lock
 SN-Tin Plated
 Pin NO.

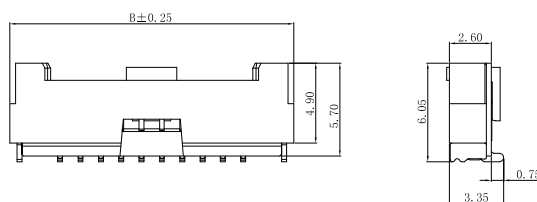
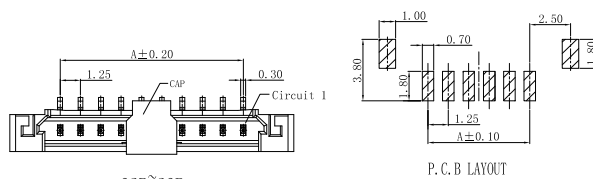

POLES	Dimensions		POLES	Dimensions	
	A	B		A	B
02	1.25	7.45	11	12.50	18.70
03	2.50	8.70	12	13.75	19.95
04	3.75	9.95	13	15.00	21.20
05	5.00	11.20	14	16.25	22.45
06	6.25	12.45	15	17.50	23.70
07	7.50	13.70	15	17.50	23.70
08	8.75	14.95	25	30.00	36.20
09	10.00	16.20	30	36.25	42.45
10	11.25	17.45			

Unit:mm

JVT1225W9T-XXSNL-S	PA9T UL94V-0	Brass	Tin Plated	Brass	Tin Plated	JVT1225 Housing
PART NO	Material					

JVT1225 SERIES

1.25mm pitch wire to board connector

JVT1225W

1.25mm Pitch 90° Wafer-SMT TYPE

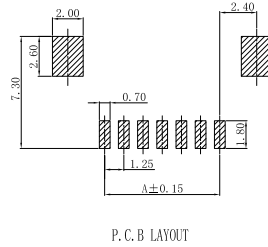
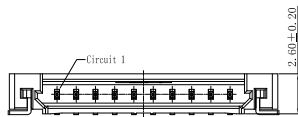
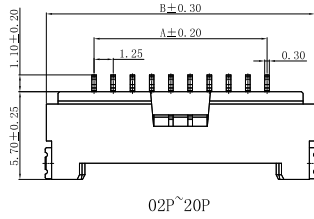
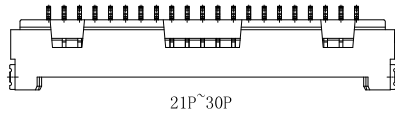

JVT1225W9T-XXSNRL-S
 Logo
 Series NO.
 Wafer
 PA9T UL94V-0
 S-SMT
 Lock
 R-Right Angle 90°
 SN-Tin Plated
 Pin NO.

POLES	Dimensions		POLES	Dimensions	
	A	B		A	B
02	1.25	7.45	11	12.50	18.70
03	2.50	8.70	12	13.75	19.95
04	3.75	9.95	13	15.00	21.20
05	5.00	11.20	14	16.25	22.45
06	6.25	12.45	15	17.50	23.70
07	7.50	13.70	20	23.75	29.95
08	8.75	14.95	25	30.00	36.20
09	10.00	16.20	30	36.25	42.45
10	11.25	17.45			

JVT1225W9T-XXSNRL-S	PA9T UL94V-0	Brass	Tin Plated	Brass	Tin Plated	JVT1225 Housing
PART NO	Material	Material(Pin)	Finish(Pin)	Material (Solder Tabs)	Finish (Solder Tabs)	Mates With Part(s)