

Specifications

- Voltage rating: 250V AC, DC
- Current Rating: 3A, AC, DC
- Withstand voltage: 1000V AC/minute
- Contact resistance: 20mΩ max
- Insulation resistance: 1000MΩ min
- Temperature range: -40°C ~ +105°C
- *Suitable JVT1135T series Terminal
JVT1136W series Wafer
- Compliant with RoHS and REACH
Contact JVT for details

Assembly layout

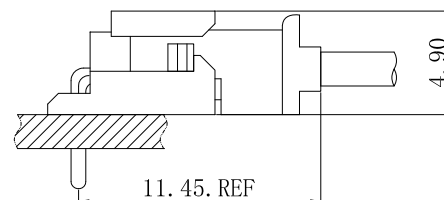
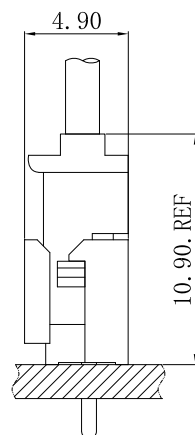

JVT1135H

2.5mm Pitch housing

HOUSING

Part No. : JVT1135HN0-XXXX

Material: Nylon 66 UL94V-0

Mates With Part(s): JVT1135 Terminal

JVT1135HN0-XXXX
Logo
Series NO.
Housing
PA66 UL94V-0
BE-Beige
Blank-natural
Pin NO.

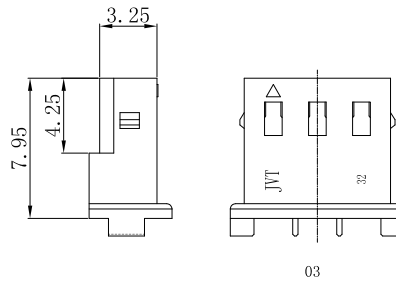
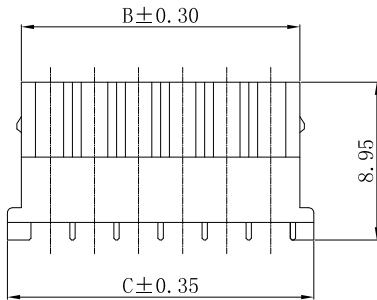
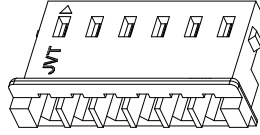
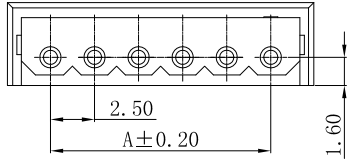

PIN	DIM. (mm)		
	A	B	C
02	2.50	5.90	7.50
03	5.00	8.40	10.00
04	7.50	10.90	12.50
05	10.00	13.40	15.00
06	12.50	15.90	17.50
07	15.00	18.40	20.00
08	17.50	20.90	22.50
09	20.00	23.40	25.00
10	22.50	25.90	27.50
11	25.00	28.40	30.00
12	27.50	30.90	32.50
13	30.00	33.40	35.00
14	32.50	35.90	37.50
15	35.00	38.40	40.00
16	37.50	40.90	42.50

JVT1135T

2.5mm Pitch Crimp Terminal

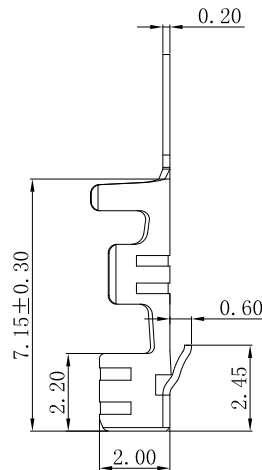
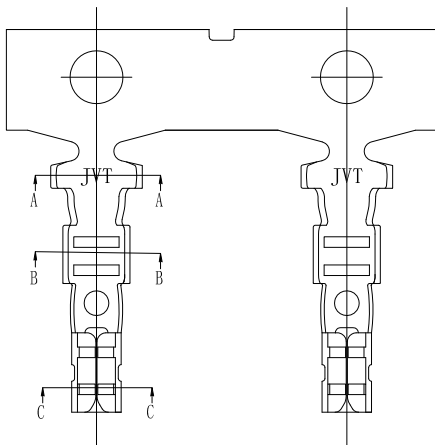

JVT1135TP-SNS
Logo
Series NO.
T-Terminal
P-Phosphor bronze
S-Stamping before Plating
SN-Tin Plated

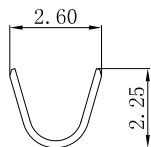

SEC:A-A

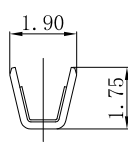

SEC:B-B

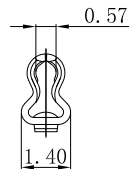

SEC:C-C

JVT1135TP-SNS	Phos Bronze	Tin Plated	AWG#22~28	1.9mm(Max)	JVT1135 HOUSING
PART N0	Material	Finish(Pin)	Wire Range	Insulation O.D.	Mates With Part(s)

JVT1136WR

2.5mm Pitch 90°Wafer-DIP TYPE

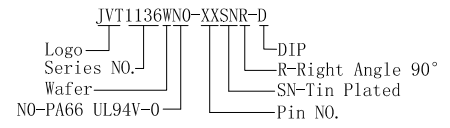
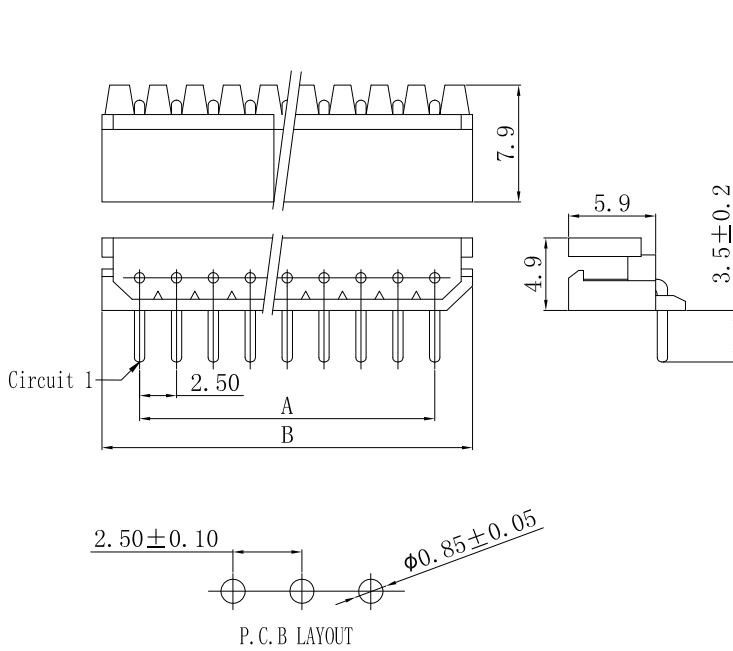

Poles	Dimensions		Poles	Dimensions	
	A	B		A	B
02	2.50	7.50	11	25.00	30.00
03	5.00	10.00	12	27.50	32.50
04	7.50	12.50	13	30.00	35.00
05	10.00	15.00	14	32.50	37.50
06	12.50	17.50	15	35.00	40.00
07	15.00	20.00	16	37.50	42.50
08	17.50	22.50	17	40.00	45.00
09	20.00	25.00	18	42.50	47.50
10	22.50	27.50			

JVT1136WN0-XXSNR-D	PA66 UL94V-0	Brass	Tin Plated	JVT1135 Housing
PART NO	Material	Material(Pin)	Finish(Pin)	Mates With Part(s)

JVT1136W

2.5mm Pitch 180°Wafer-DIP TYPE

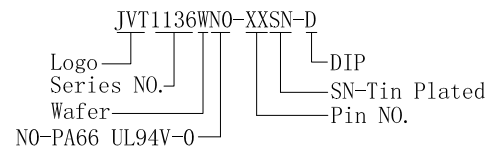
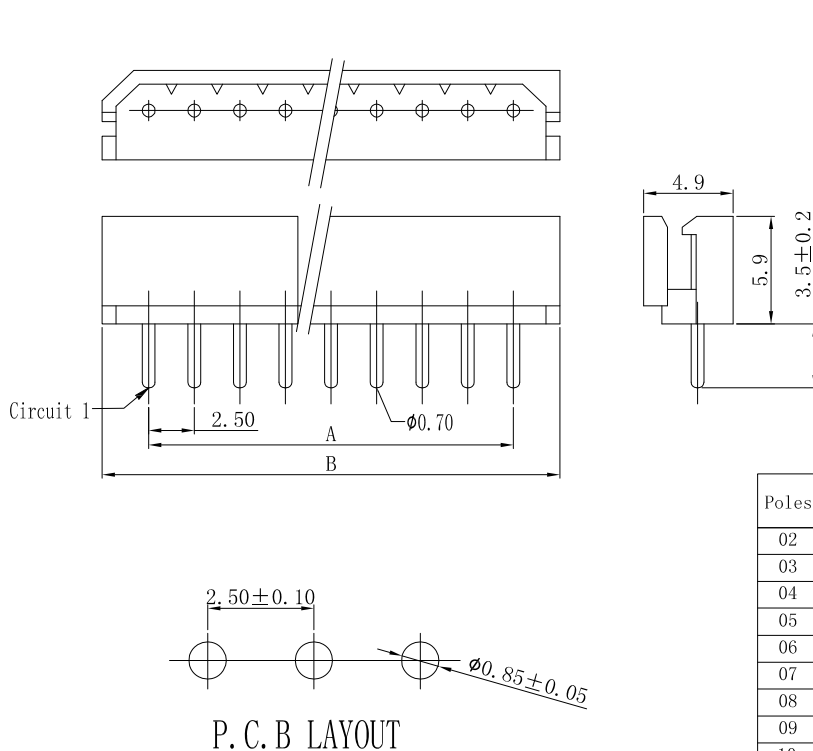

Poles	Dimensions		Poles	Dimensions	
	A	B		A	B
02	2.50	7.50	11	25.00	30.00
03	5.00	10.00	12	27.50	32.50
04	7.50	12.50	13	30.00	35.00
05	10.00	15.00	14	32.50	37.50
06	12.50	17.50	15	35.00	40.00
07	15.00	20.00	16	37.50	42.50
08	17.50	22.50	17	40.00	45.00
09	20.00	25.00	18	42.50	47.50
10	22.50	27.50			

JVT1136WN0-XXSN-D	PA66 UL94V-0	Brass	Tin Plated	JVT1135 Housing
PART NO	Material	Material(Pin)	Finish(Pin)	Mates With Part(s)