

Specifications

- Voltage rating: 150V AC, DC
- Current Rating: 3A, AC, DC
- Withstand voltage: 500V AC/minute
- Contact resistance: 20mΩ max
- Insulation resistance: 1000MΩ min
- Temperature range: -40°C ~ +105°C
- Compliant with RoHS and REACH
- Contact JVT for details

Assembly layout

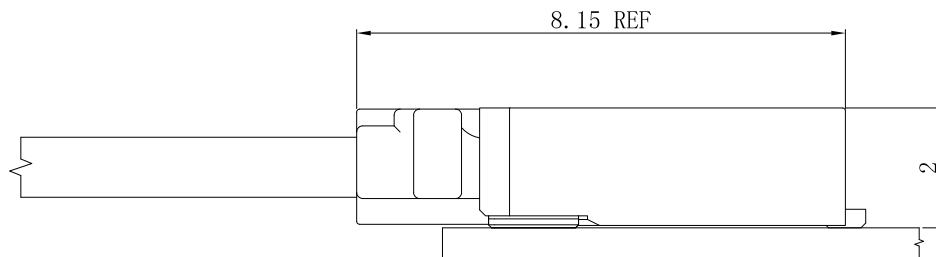

JVT1505 SERIES

1.5mm pitch wire to board connector

JVT1505H

1.5mm Pitch housing

HOUSING

Part No. : JVT1505HN0-XXXX

Material: Nylon 66 UL94V-0

Mates With Part(s): JVT1505 Terminal

JVT1505HN0-XXXX

Logo
Series NO.
Housing
PA66 UL94V-0

— WH-White
— BK-Black
— Pin NO.

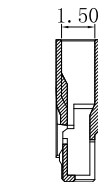
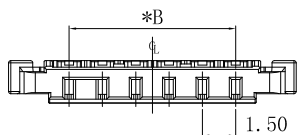
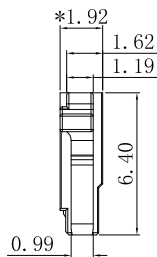
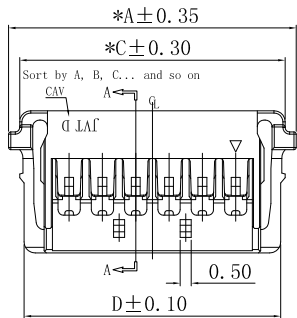
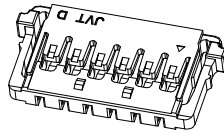
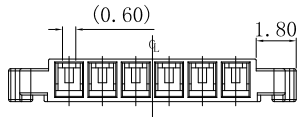

SECTION A-A

Poles	Dimensions (mm)			
	A	B	C	D
02	6.95	1.5	5.95	5.55
03	8.45	3.0	7.45	7.05
04	9.95	4.5	8.95	8.55
05	11.45	6.0	10.45	10.05
06	12.95	7.5	11.95	11.55
07	14.45	9.0	13.45	13.05
08	15.95	10.5	14.95	14.55
09	17.45	12.0	16.45	16.05
10	18.95	13.5	17.95	17.55
11	20.45	15.0	19.45	19.05
12	21.95	16.5	20.95	20.55

Unit:mm

JVT1505T

1.5mm Pitch Crimp Terminal

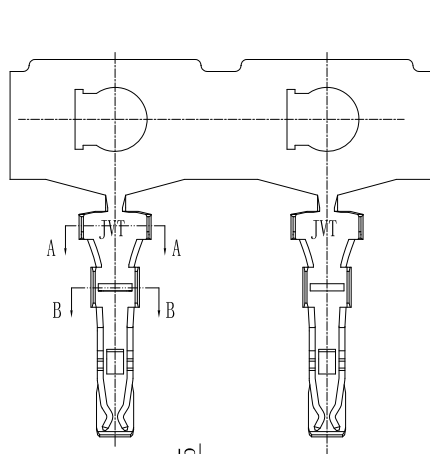

*0.150 ± 0.03

JVT1505TP-GAS

Logo
Series NO.
T-Terminal
P-Phosphor bronze

— S-Stamping before Plating
— GA-All gold plating

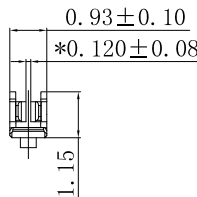
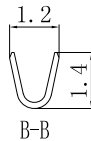
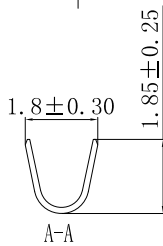
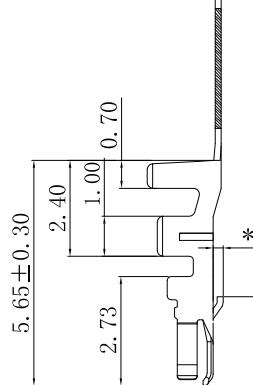

JVT1505TP-GAS	Phos Bronze	Gold Plated	AWG#24-28	1.1mm(Max)	JVT1505 HOUSING
PART NO	Material	Finish(Pin)	Wire Range	Insulation O.D.	Mates With Part(s)

JVT1505 SERIES

1.5mm pitch wire to board connector

JVT1505W

1.5mm Pitch 90° Wafer-SMT TYPE

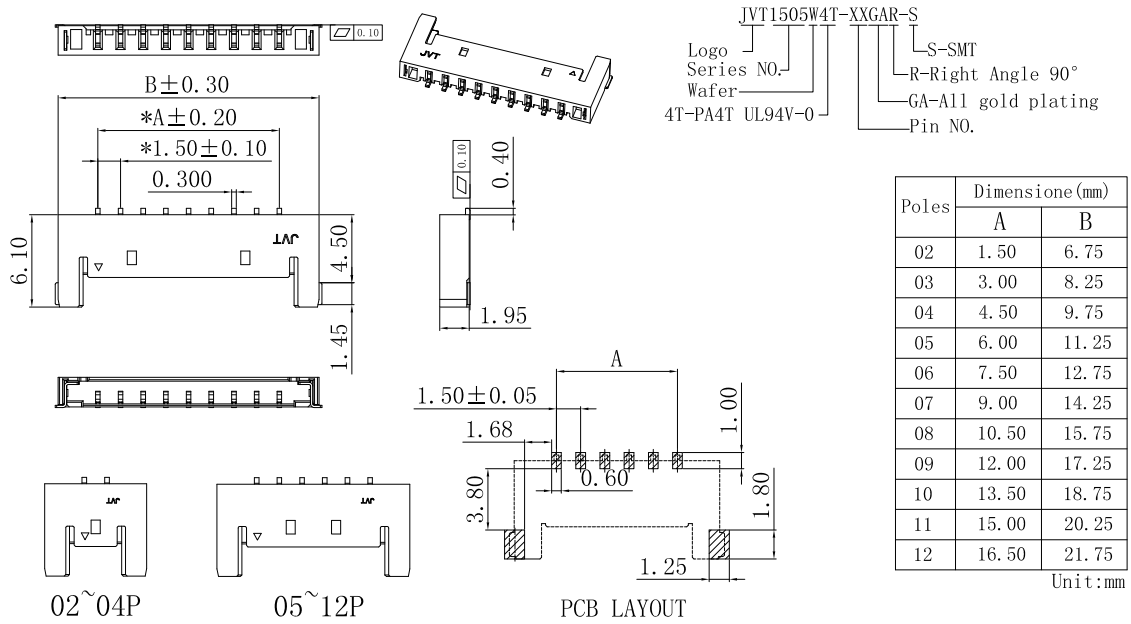

JVT1505W4T-XXGAR-S	PA4T UL94V-0	Phos Bronze	Gold Plated	Brass	Gold Plated	JVT1505 Housing
PART NO	Material	Material(Pin)	Finish(Pin)	Material (Solder Tabs)	Finish (Solder Tabs)	Mates With Part(s)