

Specifications

- Voltage rating: 50V AC, DC
- Current Rating: 1A, AC, DC
- Withstand voltage: 500V AC/minute
- Contact resistance: 50m Ω max
- Insulation resistance: 100m Ω min
- Temperature range: -40 $^{\circ}$ C ~ +105 $^{\circ}$ C
- Compliant with RoHS and REACH
- Contact JVT for details

Assembly layout

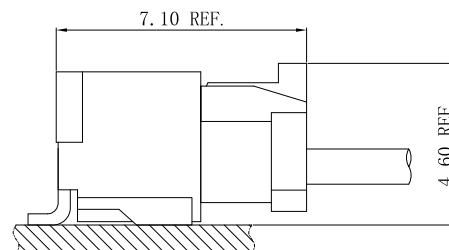
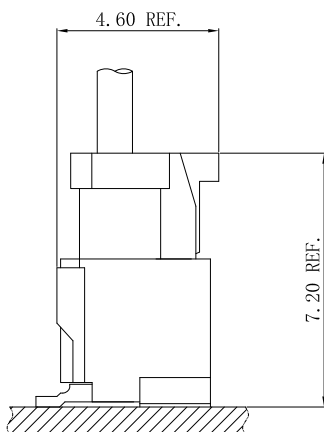

JVT1257 SERIES

1.25mm pitch wire to board connector

JVT1257H

1.25mm Pitch housing

HOUSING

Part No. : JVT1257HNO-XXBKL

Material: Nylon 66 UL94V-0

Mates With Part(s): JVT1257 Terminal

JVT1257HNO-XXL
Logo Series NO. Housing Lock Pin NO. PA66 UL94V-0

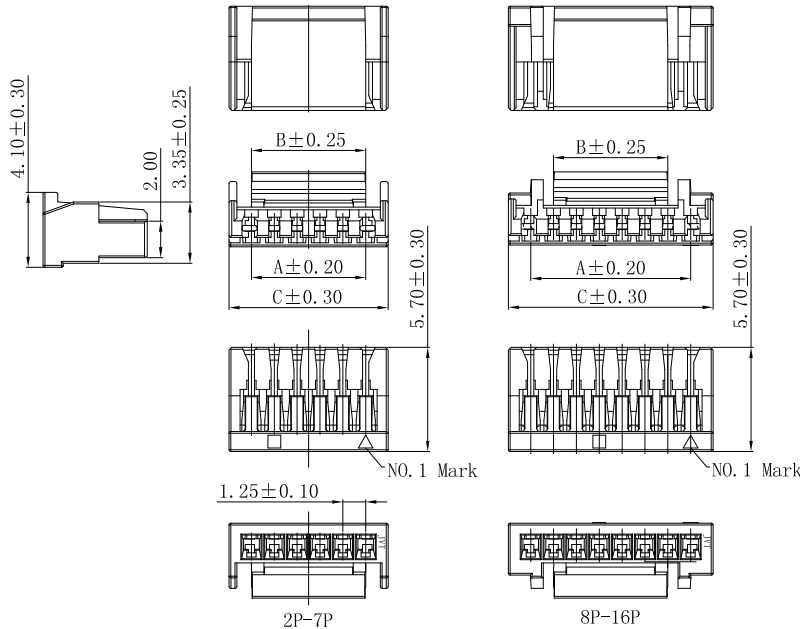

Poles	A	B	C
02	1.25	1.95	3.75
03	2.50	3.20	5.00
04	3.75	4.25	6.25
05	5.00	4.25	7.50
06	6.25	6.25	8.75
07	7.50	6.25	10.00
08	8.75	6.25	11.25
09	10.00	6.25	12.50
10	11.25	8.20	13.75
11	12.25	8.20	15.00
12	13.75	8.20	16.25
13	15.00	8.20	17.50
14	16.25	8.20	18.75
15	17.50	8.20	20.00
16	18.75	8.20	21.25

Unit:mm

JVT1257T

1.25mm Pitch Crimp Terminal

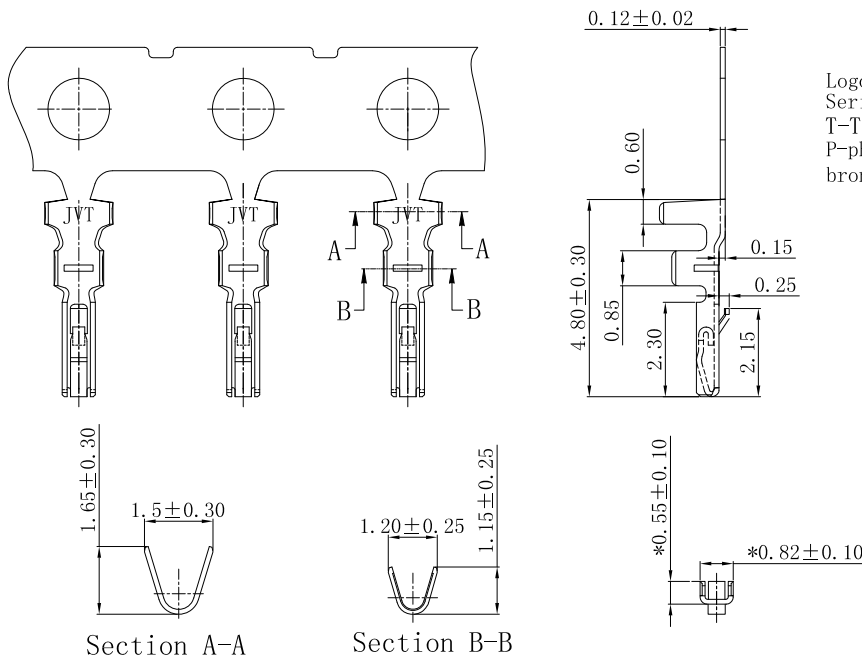

JVT1257TP-SNSL-B
Logo Series NO. T-Terminal P-phosphor bronze With rubber shell buckle S-Stamping before Plating SN-Tin Plated

JVT1257TP-SNSL-B	Phos Bronze	Tin Plated	AWG#26~30	1.00mm(Max)	JVT1257 HOUSING
PART NO	Material	Finish(Pin)	Wire Range	Insulation O.D.	Mates With Part(s)

JVT SERIES

1.25mm pitch wire to board connector

JVT1257W

1.25mm Pitch Wafer-SMT TYPE

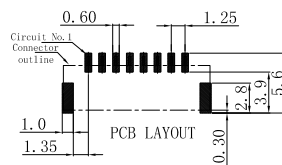
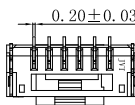
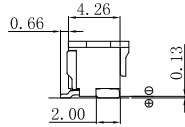
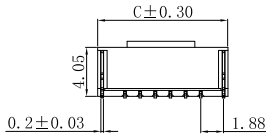
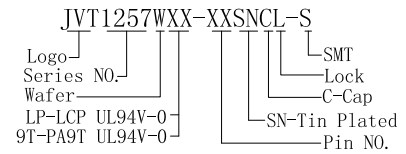
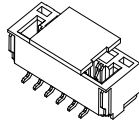
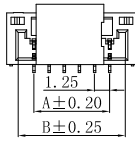

Poles	Dimensions (mm)			Poles	Dimensions (mm)		
	A	B	C		A	B	C
02	1.25	3.85	5.75	10	11.25	13.85	15.75
03	2.50	5.10	7.00	11	12.50	15.10	17.00
04	3.75	6.35	8.25	12	13.75	16.35	18.25
05	5.00	7.60	9.50	13	15.00	17.60	19.50
06	6.25	8.85	10.75	14	16.25	18.85	20.75
07	7.50	10.10	12.00	15	17.50	20.10	22.00
08	8.75	11.35	13.25	16	18.75	21.35	23.25
09	10.00	12.60	14.50				

Unit:mm

JVT1257WLP-XXSNCL-S	LCP UL94V-0	Phos Bronze	Tin Plated	Phos Bronze	Tin Plated	JVT1257 Housing
JVT1257W9T-XXSNCL-S	PA9T UL94V-0					
PART NO	Material	Material(Pin)	Finish(Pin)	Material (Solder Tabs)	Finish (Solder Tabs)	Mates With Part(s)

JVT1257W

1.25mm Pitch 90° Wafer-SMT TYPE

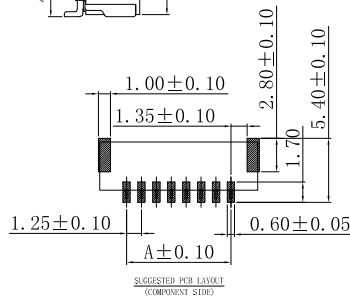
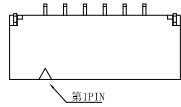
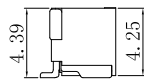
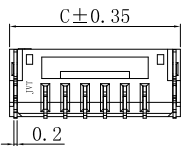
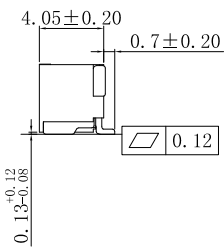
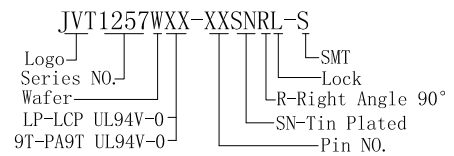
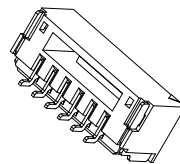
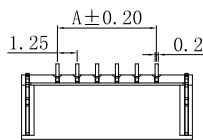

Poles	Dimensions (mm)			Poles	Dimensions (mm)		
	A	B	C		A	B	C
02	1.25	3.85	5.75	10	11.25	13.85	15.75
03	2.50	5.10	7.00	11	12.50	15.10	17.00
04	3.75	6.35	8.25	12	13.75	16.35	18.25
05	5.00	7.60	9.50	13	15.00	17.60	19.50
06	6.25	8.85	10.75	14	16.25	18.85	20.75
07	7.50	10.10	12.00	15	17.50	20.10	22.00
08	8.75	11.35	13.25	16	18.75	21.35	23.25
09	10.00	12.60	14.50				

Unit:mm

JVT1257WLP-XXSNRL-S	LCP UL94V-0	Phos Bronze	Tin Plated	Phos Bronze	Tin Plated	JVT1257 Housing
JVT1257W9T-XXSNRL-S	PA9T UL94V-0					
PART NO	Material	Material(Pin)	Finish(Pin)	Material (Solder Tabs)	Finish (Solder Tabs)	Mates With Part(s)