

Specifications

- Voltage rating: 250V AC, DC
- Current Rating: 3A, AC, DC
- Withstand voltage: 1000V AC/minute
- Contact resistance: 20mΩ max
- Insulation resistance: 1000mΩ min
- Temperature range: -40°C ~ +105°C
- *Suitable JVT2041T series Terminal
JVT2041W series Wafer
- Compliant with RoHS and REACH
Contact JVT for details

Assembly layout

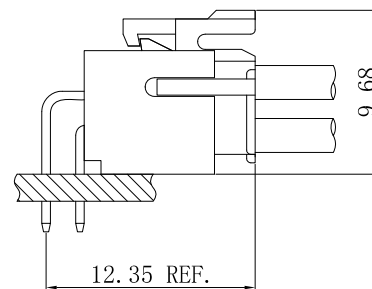
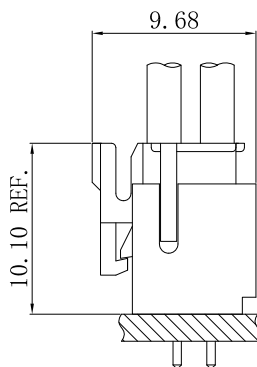

JVT2041T

2.0mm Pitch Crimp Terminal

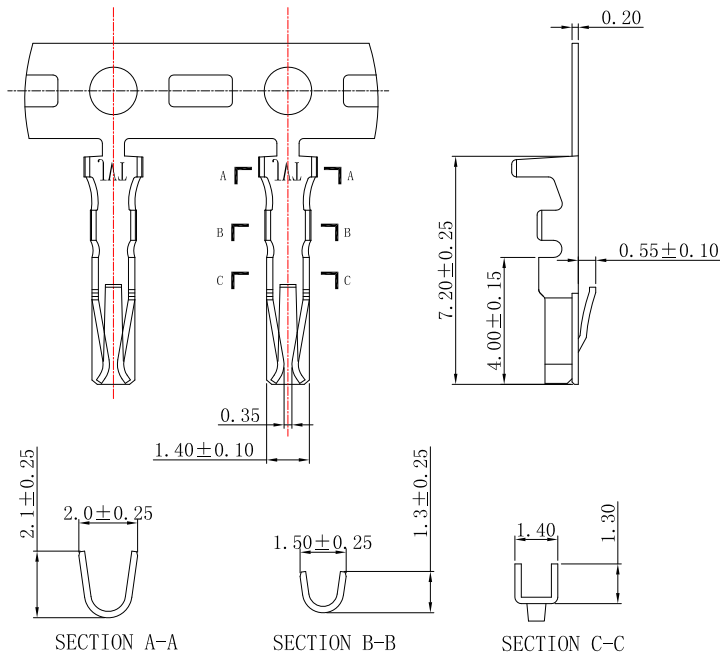

JVT2041TP-SNSFS
 Logo
 Series NO.
 T-Terminal
 P-phosphor
 bronze
 FS-Loose terminal
 S-Stamping before
 Plating
 Tin Plated

JVT2041TP-SNSFS	Phos Bronze	Tin Plated	AWG#24~28	1.4mm(Max)	JVT2041 HOUSING
PART NO	Material	Finish(Pin)	Wire Range	Insulation O.D.	Mates With Part(s)

JVT2041T

2.0mm Pitch Crimp Terminal

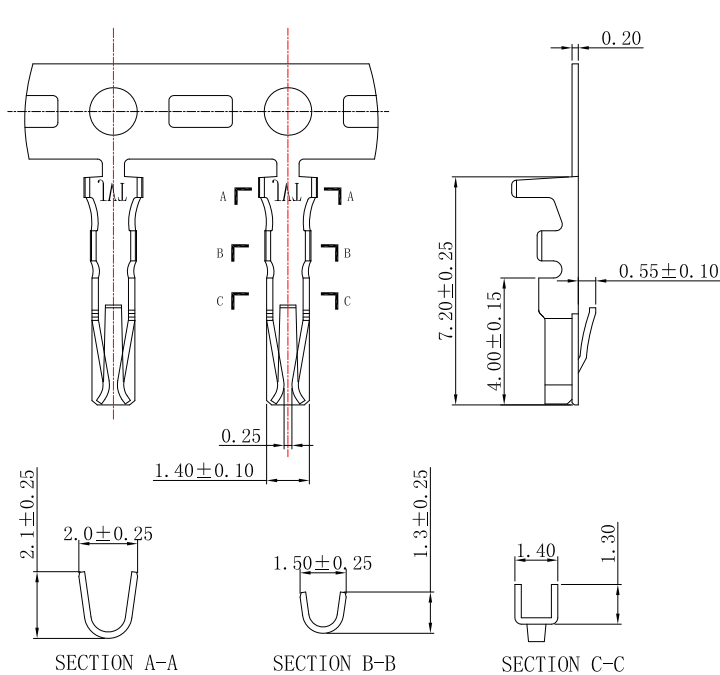

JVT2041TP-SNS
 Logo
 Series NO.
 T-Terminal
 P-phosphor
 bronze
 S-Stamping before
 Plating
 Tin Plated

JVT2041TP-SNS	Phos Bronze	Tin Plated	AWG#24~28	1.4mm(Max)	JVT2041 HOUSING
PART NO	Material	Finish(Pin)	Wire Range	Insulation O.D.	Mates With Part(s)

JVT2041W — 2.0mm Pitch Wafer-SMT TYPE

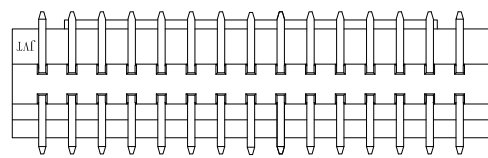
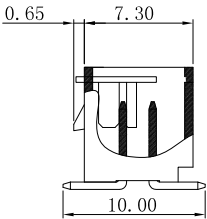
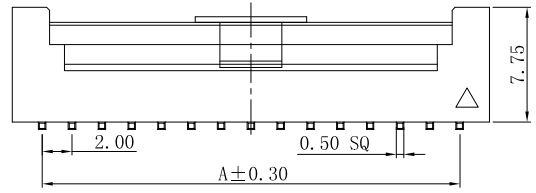
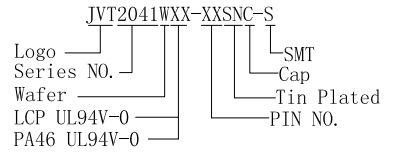
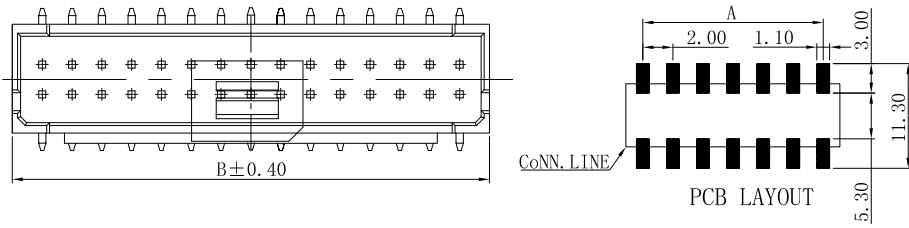

PIN	"A"	"B"	PIN	"A"	"B"
04	2.00	6.00	28PIN	26.00	30.00
06	4.00	8.00	30PIN	28.00	32.00
08	6.00	10.00	32PIN	30.00	34.00
10	8.00	12.00	34PIN	32.00	36.00
12	10.00	14.00	36PIN	34.00	38.00
14	12.00	16.00	38PIN	36.00	40.00
16	14.00	18.00	40PIN	38.00	42.00
18	16.00	20.00	42PIN	40.00	44.00
20	18.00	22.00	44PIN	42.00	46.00
22	20.00	24.00	46PIN	44.00	48.00
24	22.00	26.00	48PIN	46.00	50.00
26	24.00	28.00	50PIN	48.00	52.00

JVT2041WLP-XXSNC-S	LCP UL94V-0	Brass	Tin Plated	JVT2041 Housing
JVT2041W46-XXSNC-S	PA46 UL94V-0			
PART NO	Material	Material(Pin)	Finish(Pin)	Mates With Part(s)

JVT2041W — 2.0mm Pitch 90°Wafer-SMT TYPE

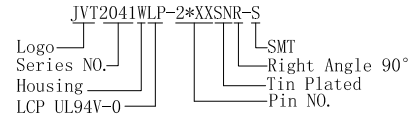
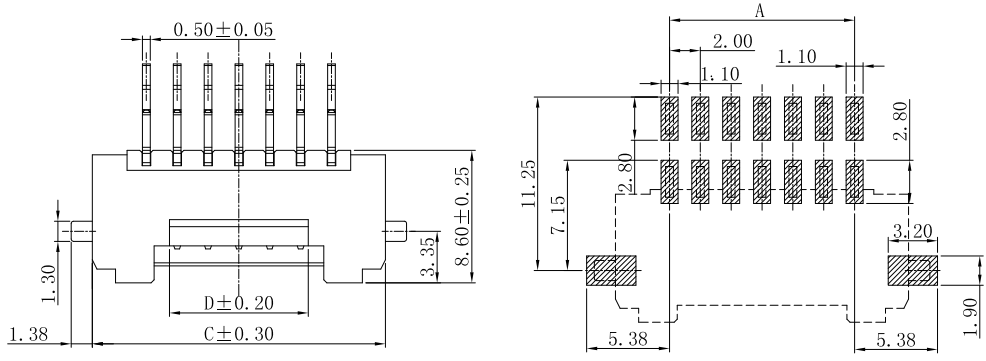

P. C. B LAYOUT (Tolerance: ± 0.05)

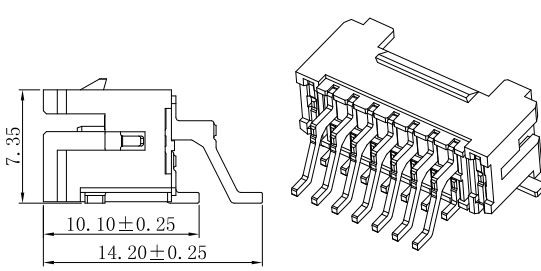
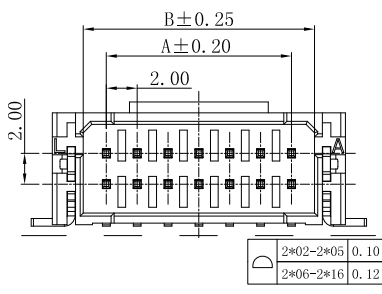

Poles	Dimensions			
	A	B	C	D
2*02	2.00	5.00	9.00	3.00
2*03	4.00	7.00	11.00	3.00
2*04	6.00	9.00	13.00	3.00
2*05	8.00	11.00	15.00	5.00
2*06	10.00	13.00	17.00	7.00
2*07	12.00	15.00	19.00	9.00
2*08	14.00	17.00	21.00	11.00
2*09	16.00	19.00	23.00	13.00
2*10	18.00	21.00	25.00	15.00
2*11	20.00	23.00	27.00	17.00
2*12	22.00	25.00	29.00	19.00
2*13	24.00	27.00	31.00	21.00
2*14	26.00	29.00	33.00	23.00
2*15	28.00	31.00	35.00	25.00
2*16	30.00	33.00	37.00	27.00

JVT2041WLP-2*XXSNR-S	LCP UL94V-0	Brass	Tin Plated	JVT2041 Housing
PART NO	Material	Material(Pin)	Finish(Pin)	Mates With Part(s)

JVT2041W — 2.0mm Pitch 90°Wafer-DIP TYPE

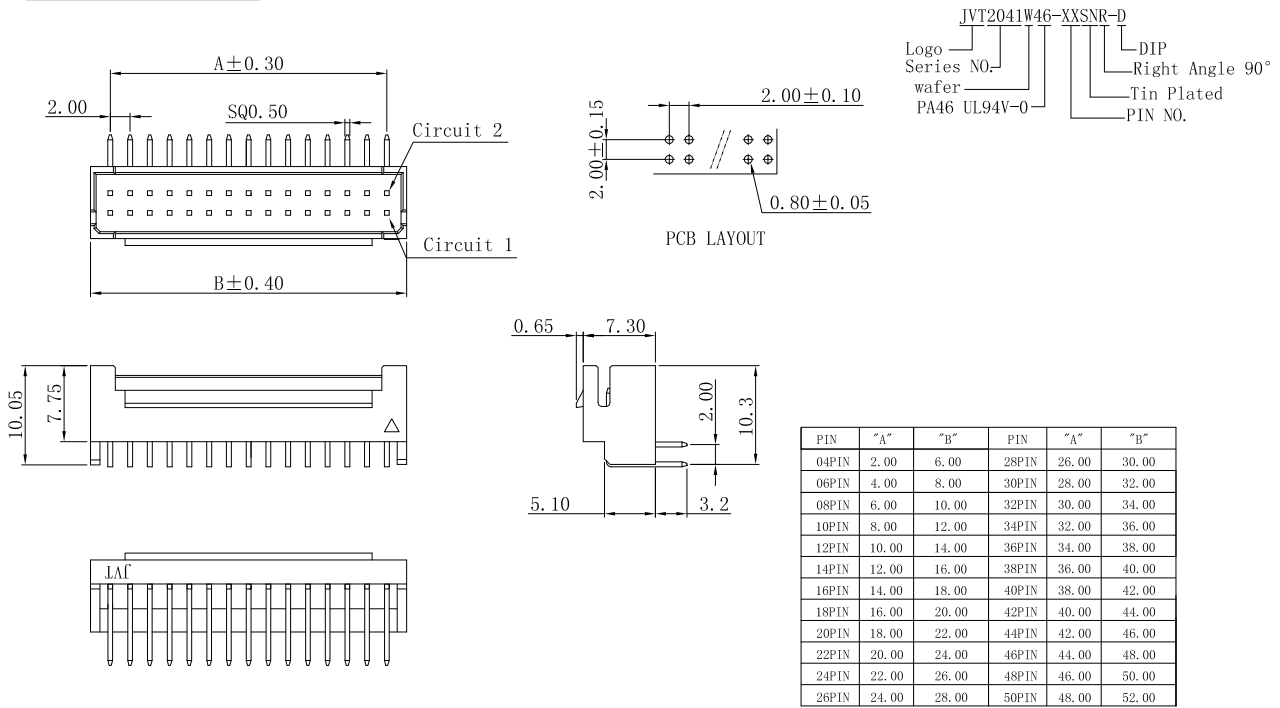

JVT2041W46-XXSNR-D	PA46 UL94V-0	Brass	Tin Plated	JVT2041 Housing
PART NO	Material	Material(Pin)	Finish(Pin)	Mates With Part(s)

JVT2041W — 2.0mm Pitch 90°Wafer-SMT TYPE

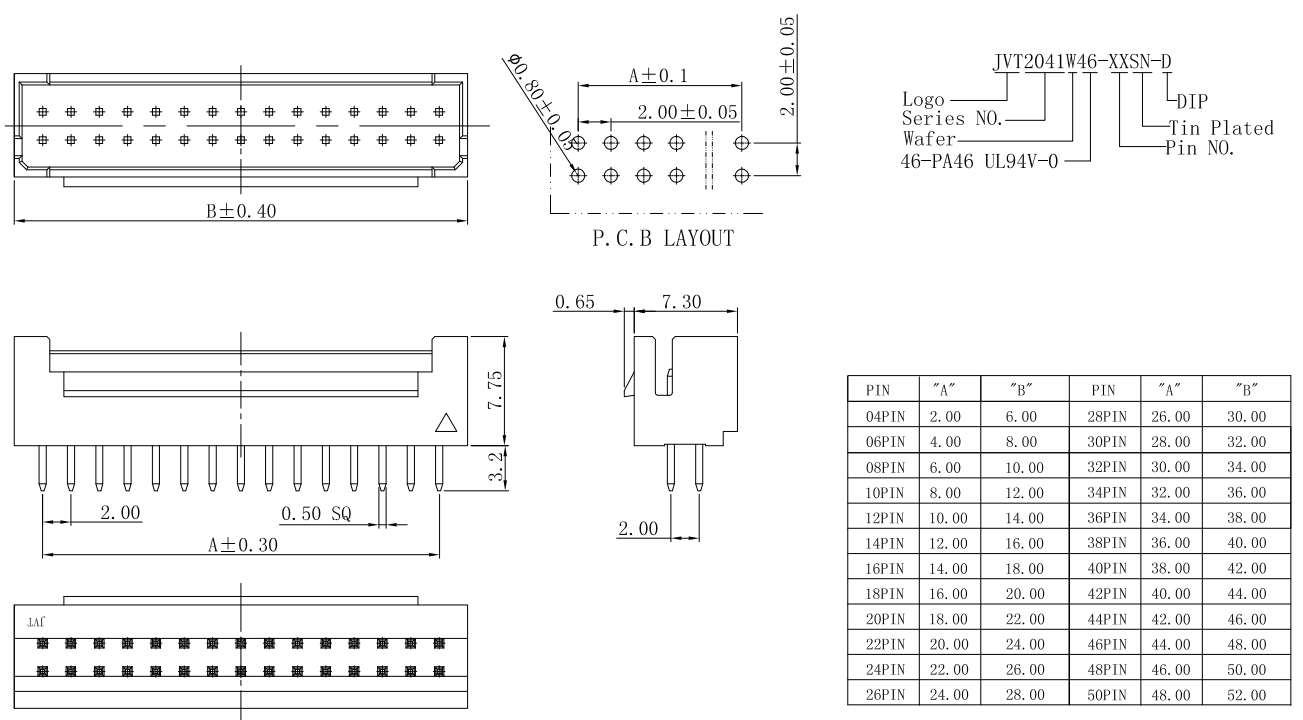

JVT2041W46-XXSN-D	PA46 UL94V-0	Brass	Tin Plated	JVT2041 Housing
PART NO	Material	Material(Pin)	Finish(Pin)	Mates With Part(s)

JVT2041H

2.0mm Pitch housing

HOUSING

Part No. : JVT2041HNO-2*XXW

Material: Nylon 66 UL94V-0

Mates With Part(s) : JVT2041 Terminal

JVT2041HNO-XX

Logo
Series NO.
Housing
PA66 94V-0

Pin NO.

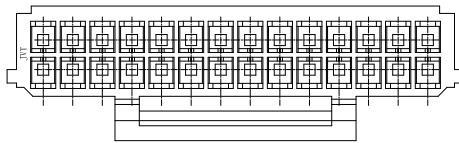
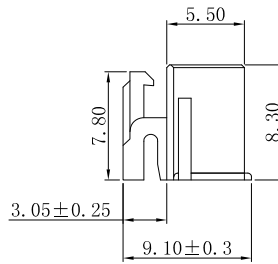
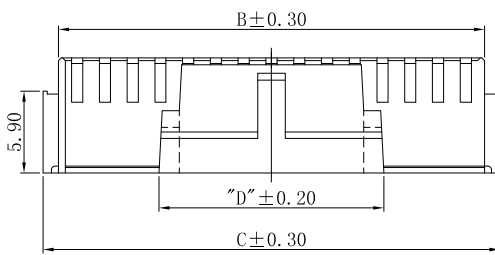
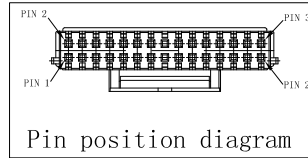
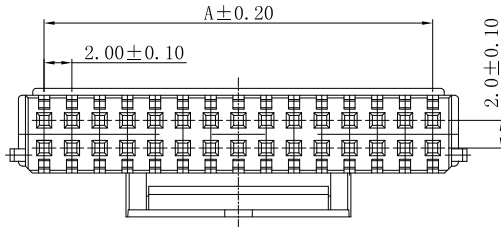

	A	B	C	D
04	2.0	4.6	6.76	3.10
06	4.0	6.6	8.76	3.10
08	6.0	8.6	10.76	4.30
10	8.0	10.6	12.76	5.70
12	10.0	12.6	14.76	7.70
14	12.0	14.6	16.76	9.70
16	14.0	16.6	18.76	11.70
18	16.0	18.6	20.76	13.70
20	18.0	20.6	22.76	15.70
22	20.0	22.6	24.76	15.70
24	22.0	24.6	26.76	15.70
26	24.0	26.6	28.76	15.70
28	26.0	28.6	30.76	15.70
30	28.0	30.6	32.76	15.70
32	30.0	32.6	34.76	15.70
34	32.0	34.6	36.76	15.70
36	34.0	36.6	38.76	15.70
38	36.0	38.6	40.76	15.70
40	38.0	40.6	42.76	15.70
42	40.0	42.6	44.76	15.70