

Specifications

- Voltage rating: 250V AC, DC
- Current Rating: 3A, AC, DC
- Withstand voltage: 1000V AC/minute
- Contact resistance: 20mΩ max
- Insulation resistance: 1000MΩ min
- Temperature range: -40°C ~ +105°C
- *Suitable JVT8001series Terminal
JVT8001series Wafer
- Compliant with RoHS and REACH
Contact JVT for details

Assembly layout

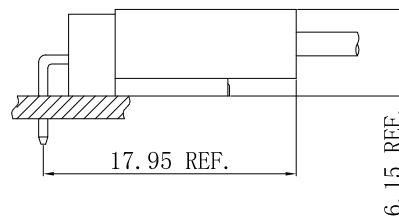
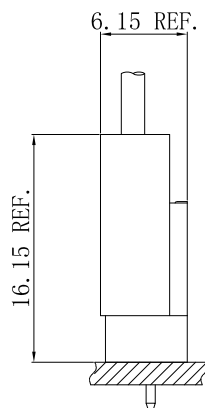

JVT8001H

2.54mm Pitch housing

HOUSING

Part No.: JVT8001HNO-XXXX

Material: PA66 UL94V-0

Mates With Part(s): JVT8001 Terminal

JVT8001HNO-XXXX
Logo Series NO. Housing NO-PA66 UL94V-0 BE-Beige WH-White Pin NO.

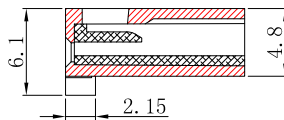
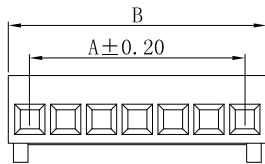
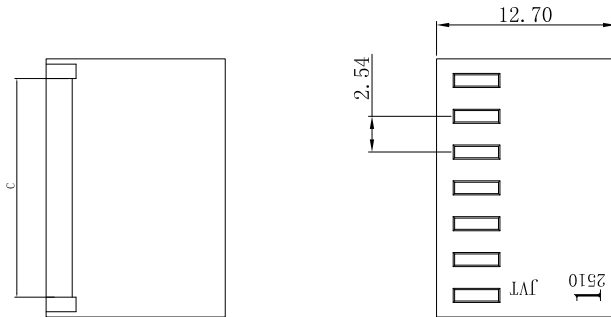

Poles	Dim (mm)		
	A	B	C
02	2.54	5.68	2.65
03	5.08	8.22	5.19
04	7.62	10.76	7.73
05	10.16	13.30	10.27
06	12.70	15.84	12.81
07	15.24	18.38	15.35
08	17.78	20.92	17.89
09	20.32	23.46	20.43
10	22.86	26.00	22.97
11	25.40	28.54	25.51
12	27.94	31.08	28.05
13	30.48	33.62	30.59
14	33.02	36.16	33.13
15	35.56	38.70	35.67
16	38.10	41.24	38.21
17	40.64	43.78	40.75
18	43.18	46.32	43.29
19	45.72	48.86	45.83
20	48.26	51.40	48.37

JVT8001T

2.54mm Pitch Crimp Terminal

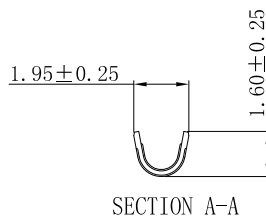
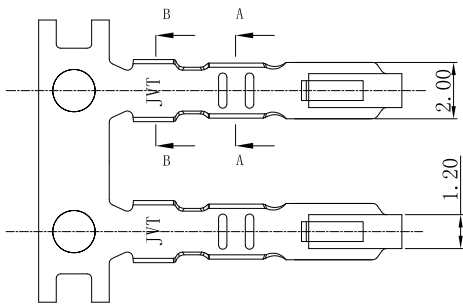

JVT8001TX-XXS
Logo Series NO. T-Terminal B-Brass P-Phosphor bronze S-Stamping before Plating T-Tin Plated GA-All gold plating GP-Gold plating

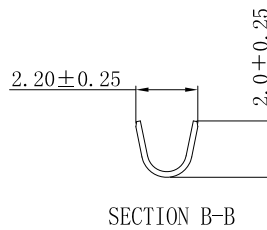
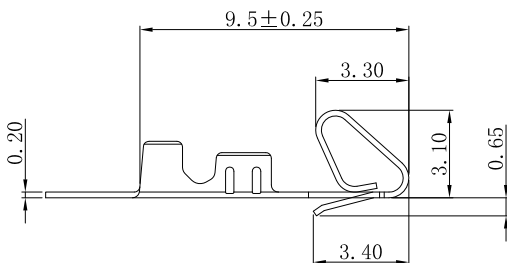

JVT8001TP-SNS	Phos Bronze	Tin Plated	AWG#22~28	1.40mm(Max)	JVT8001 HOUSING
JVT8001TP-GAS		All gold plating			
JVT8001TP-GPS		Gold plating			
PART NO	Material	Finish(Pin)	Wire Range	Insulation O.D.	Mates With Part(s)

JVT8001W — 2.54mm Pitch Wafer-SMT TYPE

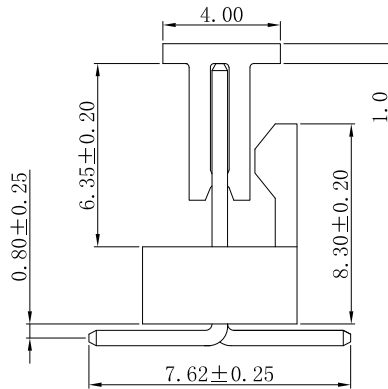
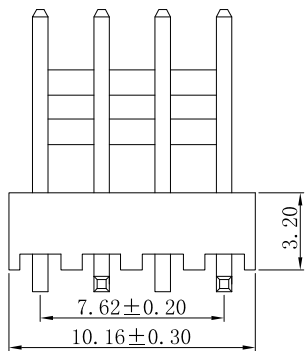
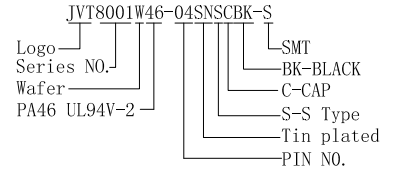
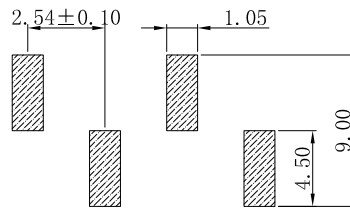
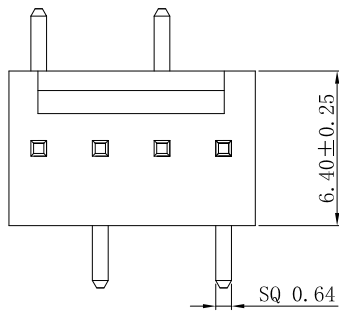

JVT8001W46-04SNSCBK-S	PA46 UL94V-0	Brass	Tin Plated	JVT8001 Housing
PART NO	Material	Material(Pin)	Finish(Pin)	Mates With Part(s)

JVT8001W — 2.54mm Pitch 90°Wafer-DIP TYPE

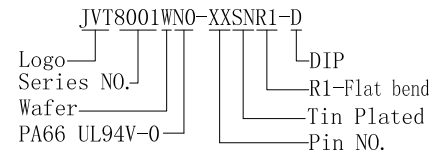
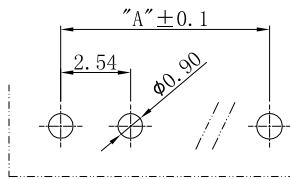
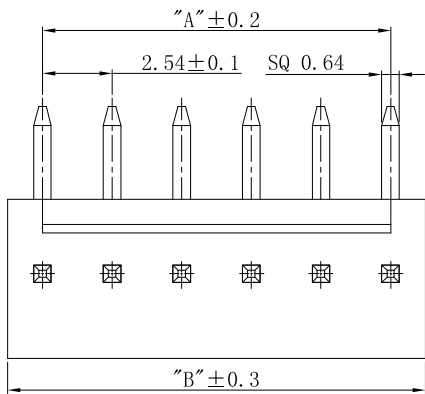

P. C. B LAYOUT

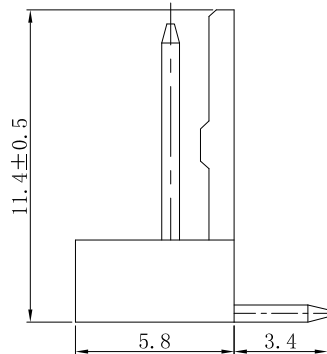
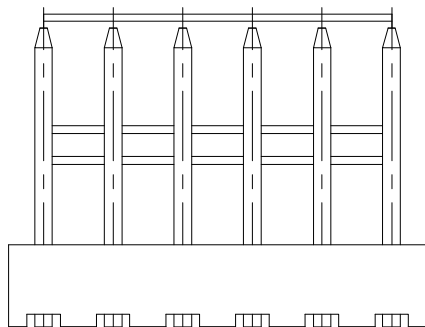

Poles	DIM		Poles	DIM	
	A	B		A	B
02	2.54	5.08	10	22.86	25.40
03	5.08	7.62	11	25.40	27.94
04	7.62	10.16	12	27.94	30.48
05	10.16	12.70	13	30.48	33.02
06	12.70	15.24	14	33.02	35.56
07	15.24	17.78	15	35.56	38.10
08	17.78	20.32	16	38.10	40.64
09	20.32	22.86	20	48.26	50.80

JVT8001WNO-XXSNR1-D	PA66 UL94V-0	Brass	Tin Plated	JVT8001 Housing
PART NO	Material	Material(Pin)	Finish(Pin)	Mates With Part(s)

JVT8001W — 2.54mm Pitch Wafer-DIP TYPE

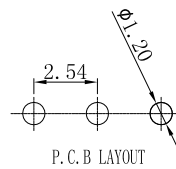
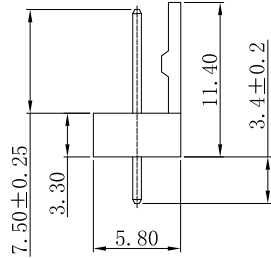
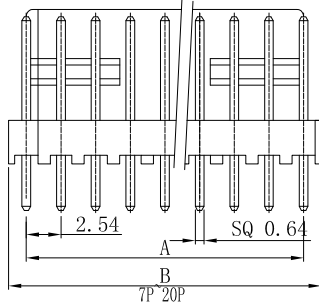
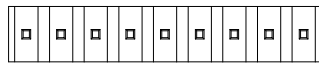

JVT8001WN0-XXSNXX-D-B
Logo
Series NO.
Wafer
PA66 UL94V-0
DIP
Blank-natural color
BE-Beige
Tin Plated
Pin NO.

Circuit 1

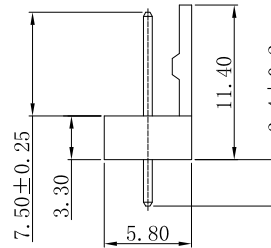
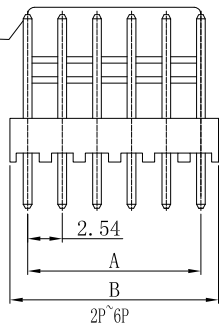

Poles	DIM		Poles	DIM	
	A	B		A	B
02	2.54	5.08	10	22.86	25.40
03	5.08	7.62	11	25.40	27.94
04	7.62	10.16	12	27.94	30.48
05	10.16	12.70	13	30.48	33.02
06	12.70	15.24	14	33.02	35.56
07	15.24	17.78	15	35.56	38.10
08	17.78	20.32	16	38.10	40.64
09	20.32	22.86	20	48.26	50.80

JVT8001WN0-XXSNXX-D-B	PA66 UL94V-0	Brass	Tin Plated	JVT8001 Housing
PART NO	Material	Material(Pin)	Finish(Pin)	Mates With Part(s)

JVT8001W — 2.5mm Pitch 90°Wafer-DIP TYPE

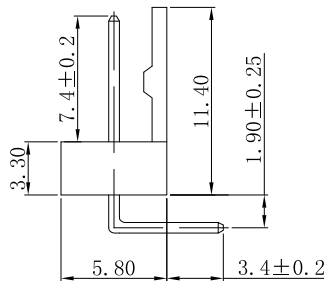
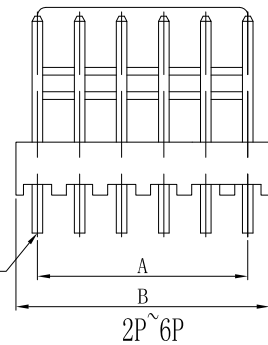

JVT8001WN2-XXSNXXR-D-B
Logo
Series NO.
Wafer
PA66 UL94V-2
DIP
R-Right Angle 90°
BK-Black
BE-Beige
Tin Plated
Pin NO.

Circuit 1

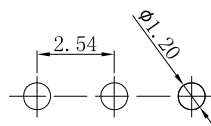
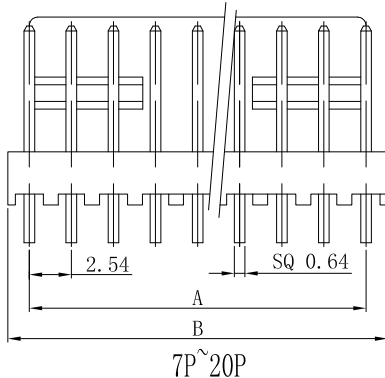

Circuit	A	B	Circuit	A	B
02	2.54	5.08	12	27.94	30.48
03	5.08	7.62	13	30.48	33.02
04	7.62	10.16	14	33.02	35.56
05	10.16	12.70	15	35.56	38.10
06	12.70	15.24	16	38.10	40.64
07	15.24	17.78	17	40.64	43.18
08	17.78	20.32	18	43.18	45.72
09	20.32	22.86	19	45.72	48.26
10	22.86	25.40	20	48.26	50.80
11	25.40	27.94			

JVT8001WN2-XXSNXXR-D-B	PA66 UL94V-2	Brass	Tin Plated	JVT8001 Housing
PART NO	Material	Material(Pin)	Finish(Pin)	Mates With Part(s)

JVT8001W

2.54mm Pitch Wafer-DIP TYPE

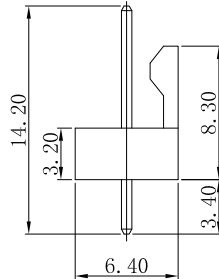
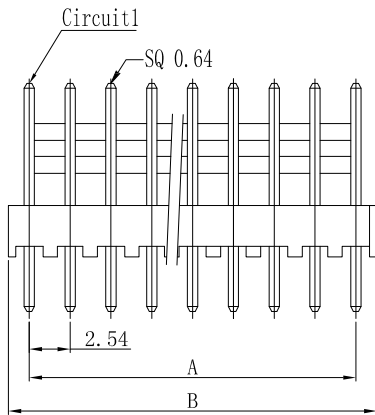

JVT8001WN2-XXSNS-D
Logo Series NO. WAFER PA66 UL94V-2
DIP S-S Type Tin plated PIN NO.

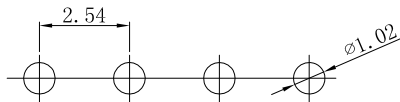

P. C. B LAYOUT

Poles	DIM		Poles	DIM	
	A	B		A	B
02	2.54	5.08	10	22.86	25.40
03	5.08	7.62	11	25.40	27.94
04	7.62	10.16	12	27.94	30.48
05	10.16	12.70	13	30.48	33.02
06	12.70	15.24	14	33.02	35.56
07	15.24	17.78	15	35.56	38.10
08	17.78	20.32	16	38.10	40.64
09	20.32	22.86	20	48.26	50.80

JVT8001WN2-XXSNS-D	PA66 UL94V-2	Brass	Tin Plated	JVT8001 Housing
PART NO	Material	Material (Pin)	Finish (Pin)	Mates With Part (s)

JVT8001W

2.5mm Pitch 90°Wafer-DIP TYPE

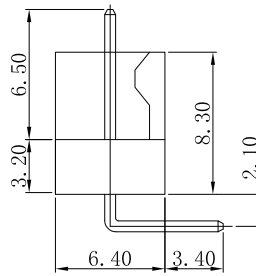
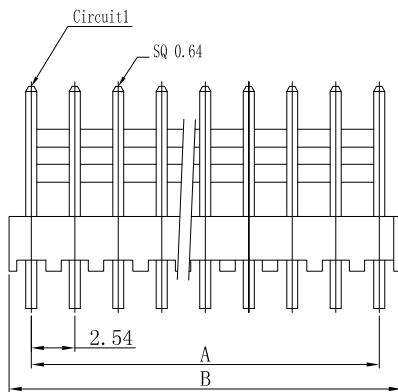

JVT8001WN2-XXSNRS-D
Logo Series NO. WAFER PA66 UL94V-2
DIP S-S Type R-Right Angle 90° Tin plated PIN NO.

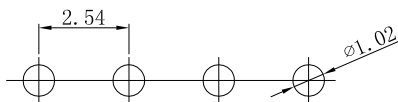

P. C. B LAYOUT

Poles	DIM		Poles	DIM	
	A	B		A	B
02	2.54	5.08	10	22.86	25.40
03	5.08	7.62	11	25.40	27.94
04	7.62	10.16	12	27.94	30.48
05	10.16	12.70	13	30.48	33.02
06	12.70	15.24	14	33.02	35.56
07	15.24	17.78	15	35.56	38.10
08	17.78	20.32	16	38.10	40.64
09	20.32	22.86	20	48.26	50.80

JVT8001WN2-XXSNRS-D	PA66 UL94V-2	Brass	Tin Plated	JVT8001 Housing
PART NO	Material	Material (Pin)	Finish (Pin)	Mates With Part (s)

JVT8001W

2.54mm Pitch Wafer-DIP TYPE

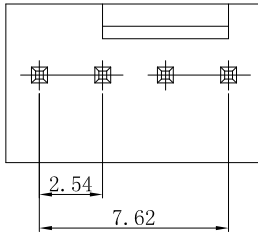

JVT8001WN2-04SNNB-D
 Logo
 Series NO.
 Wafer
 PA66 UL94V-2
 DIP
 NB-Narrow back
 SN-Tin Plated
 Pin NO.

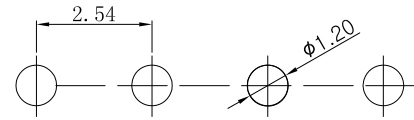
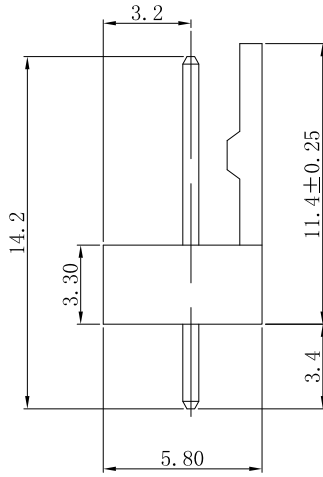
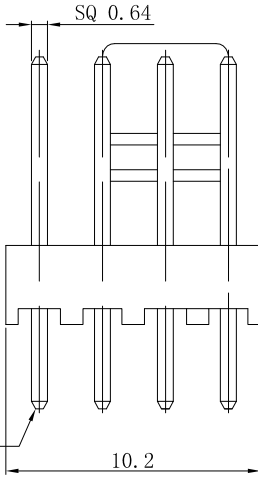

P. C. B LAYOUT

JVT8001WN2-04SNNB-D	PA66 UL94V-2	Brass	Tin Plated	JVT8001 Housing
PART NO	Material	Material(Pin)	Finish(Pin)	Mates With Part(s)